



# KITCHEN STUDIO<sup>tm</sup>

Crafting kitchens since 2006

Arch Name: Form space &  
design

Reference : Vikas Kavar

Date: 08.07.2025



---

We are not  
just  
designing  
kitchens,  
we are  
designing  
human  
Experiences.



KITCHEN STUDIO is characterised by enduring aesthetics, functionality, craftsmanship and world class quality. We know the possibilities are endless & hence we offer the most innovative and customised solutions for all your kitchen needs.





# KITCHEN ELEVATIONAL DETAILS



KITCHENSTUDIO.IN



# TYPE A - KITCHEN LAYOUT

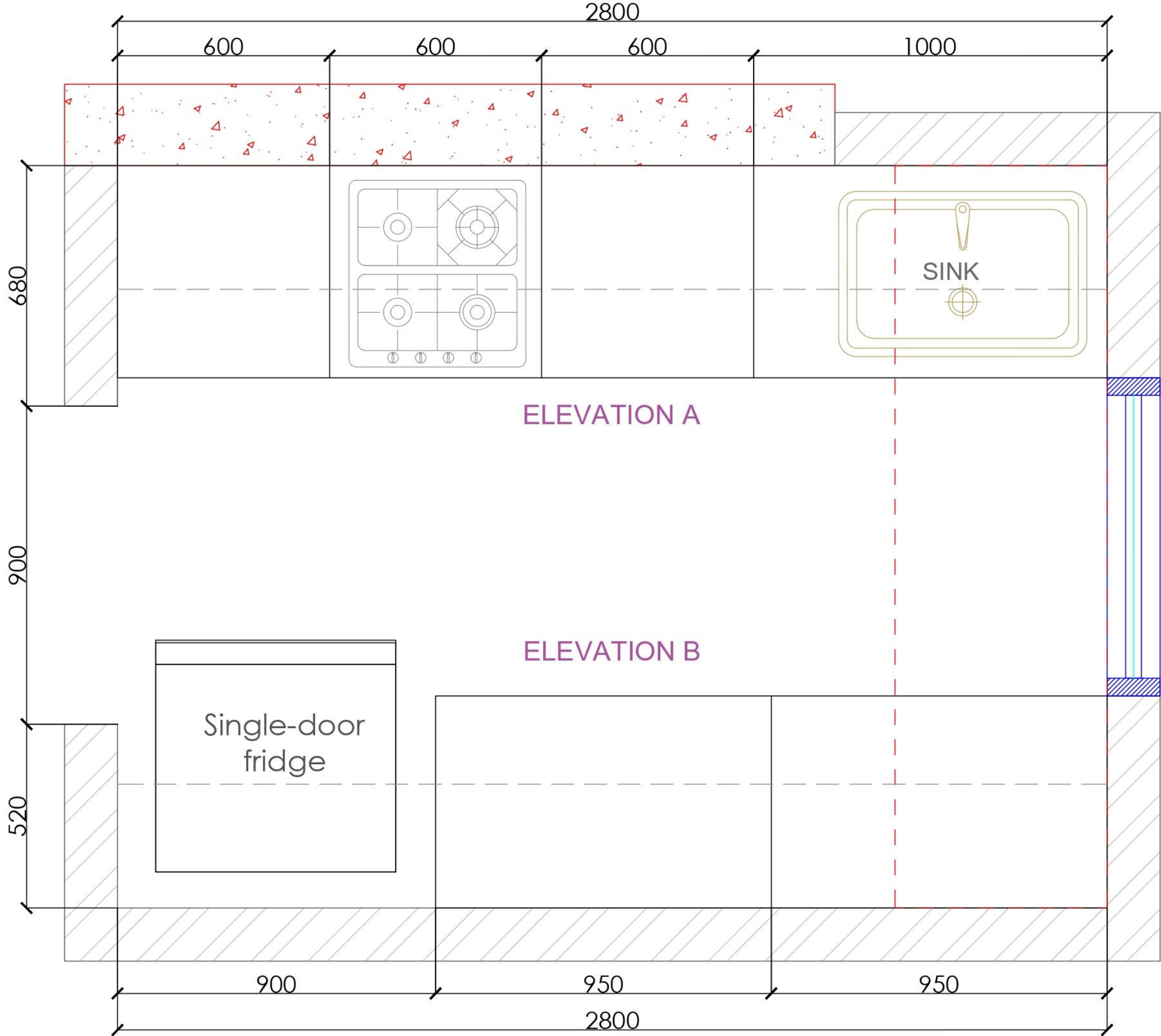

# TYPE A - OPTION 1

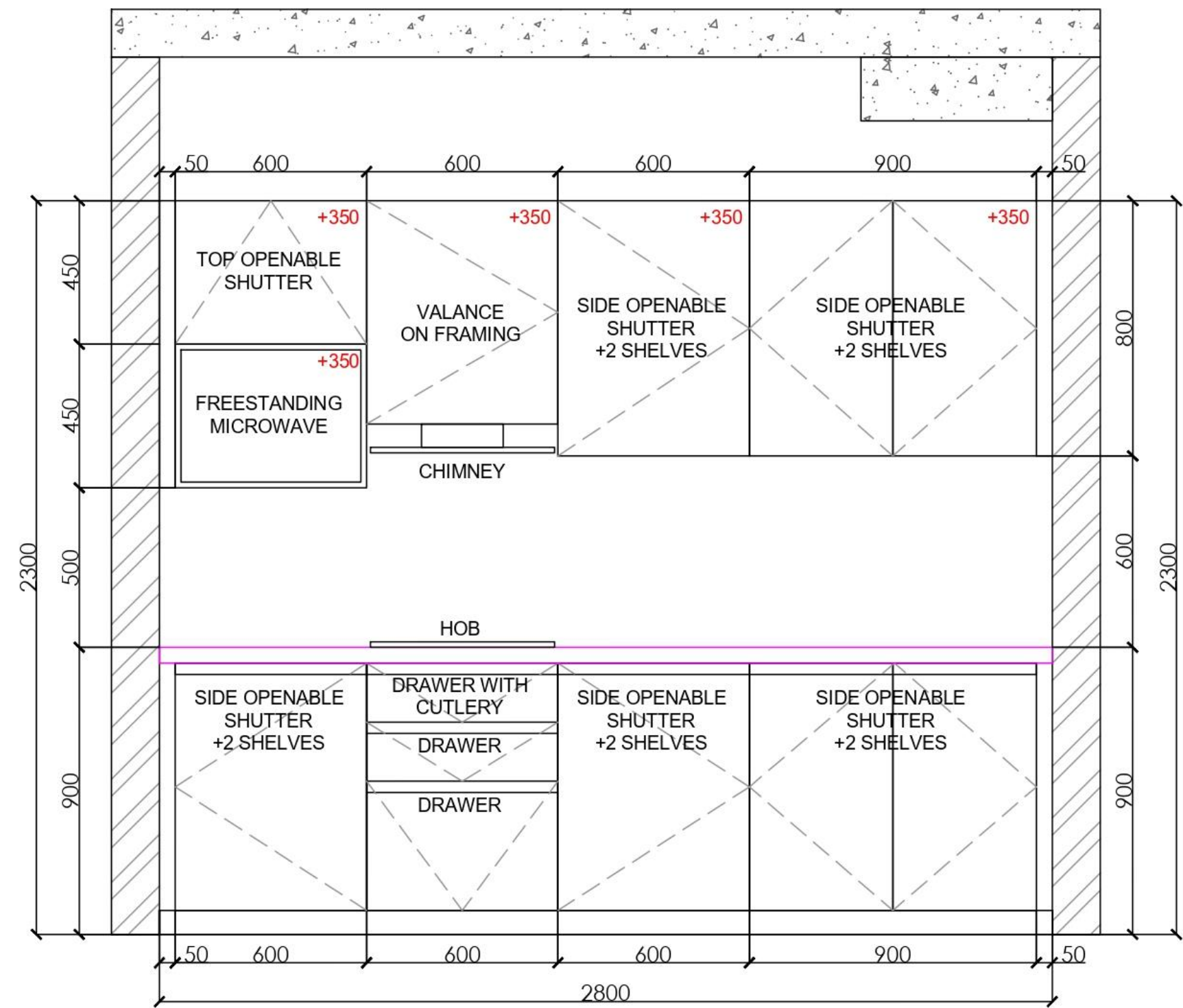

ELEVATION A

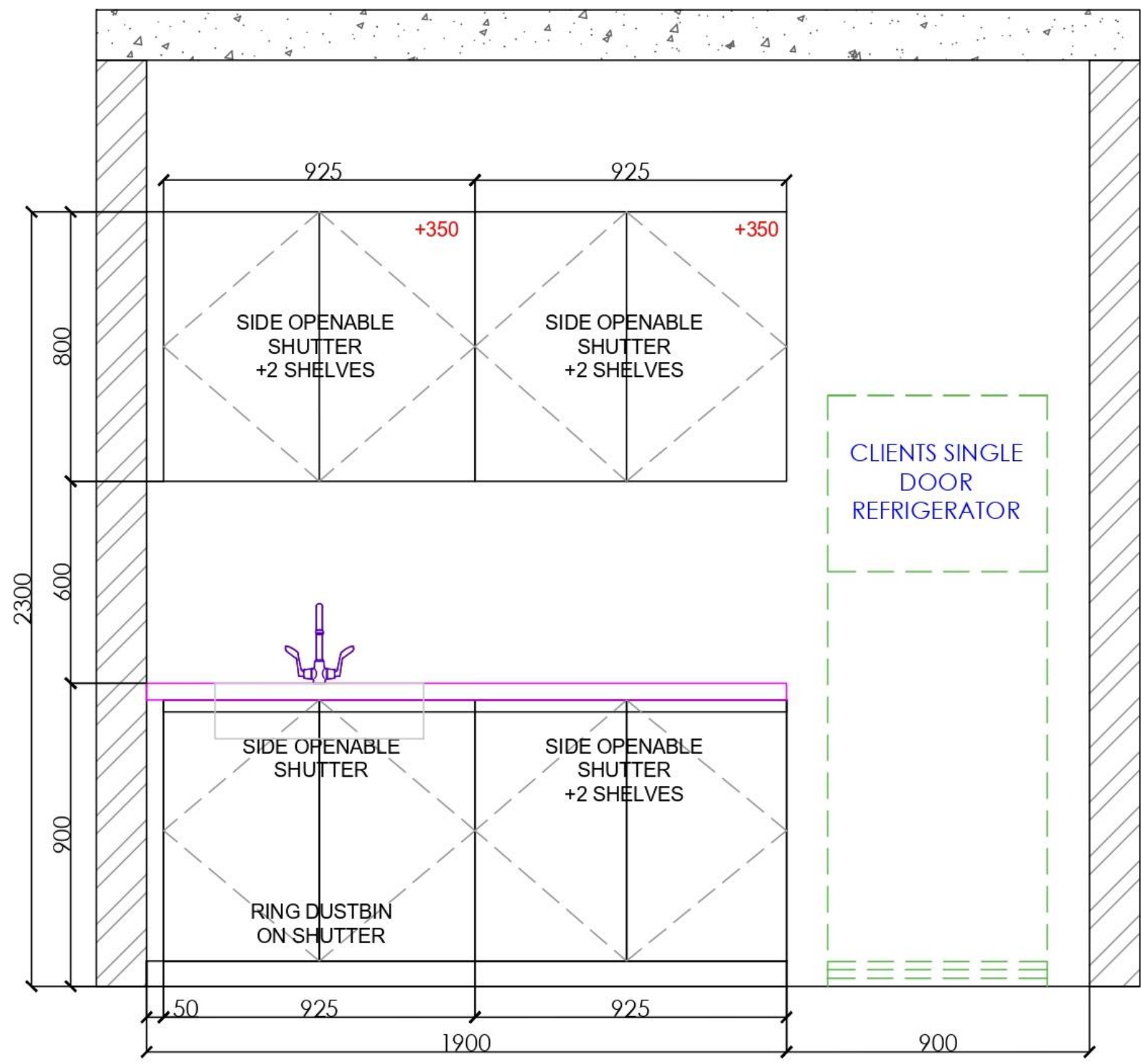

ELEVATION B

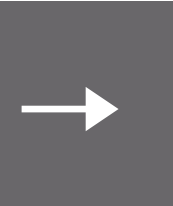



# TYPE A - OPTION 1 DETAIL



OPEN UNIT FOR MICROWAVE

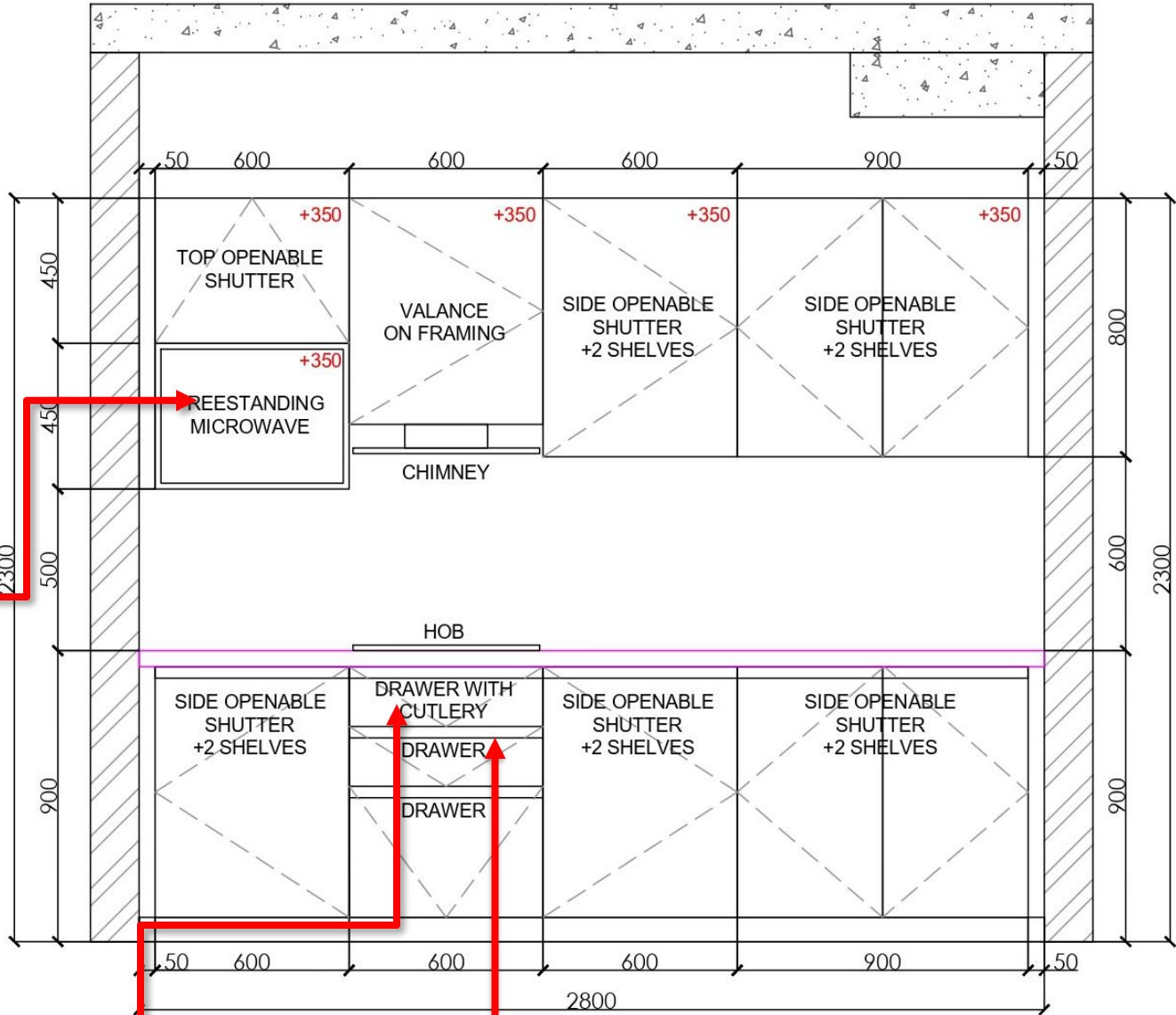

ELEVATION A



PVC CUTLERY TRAY



HETTICH-ATIRA DRAWER

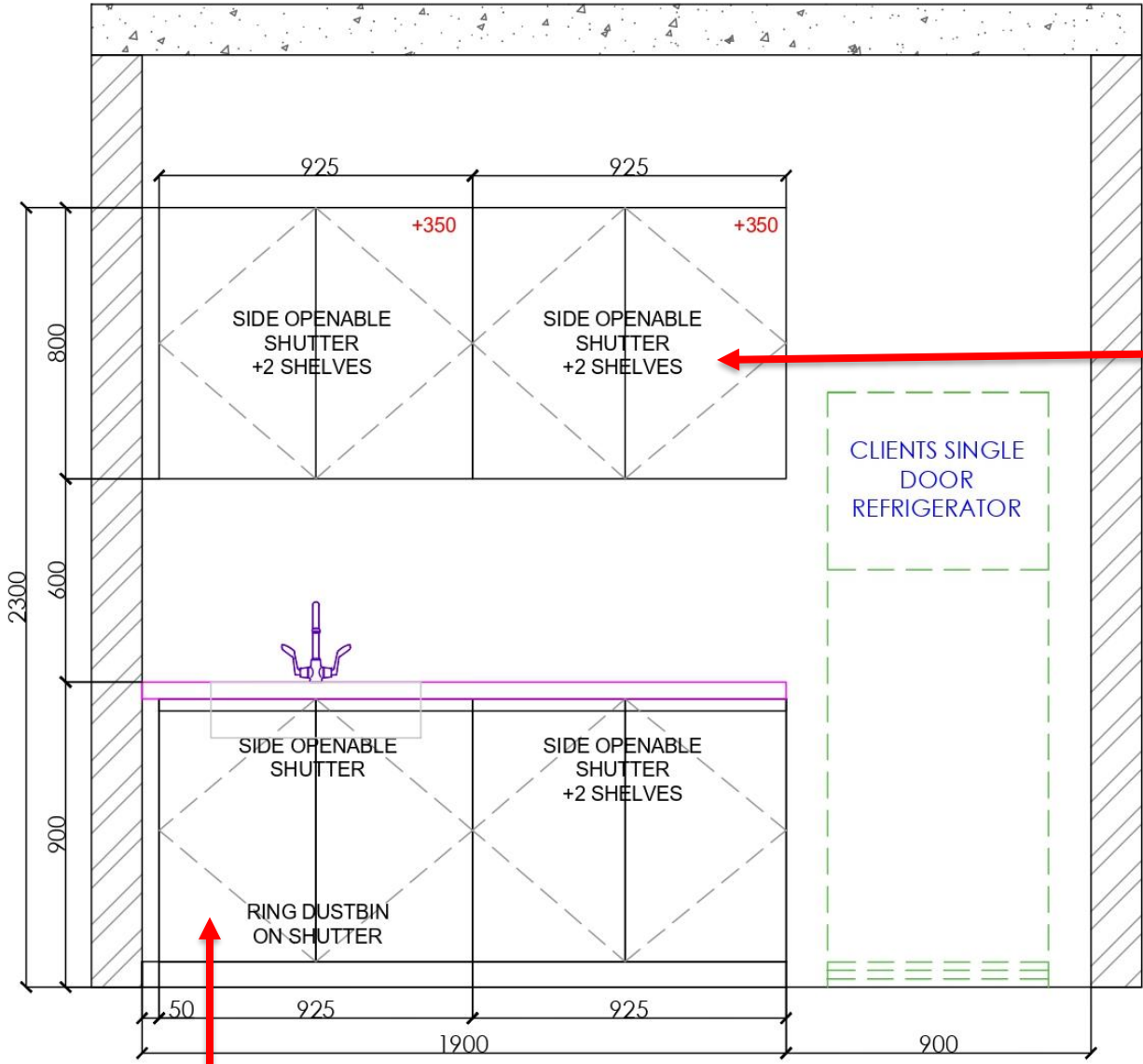

ELEVATION B



WITH 2 INTERNAL SHELF



RING DUSTBIN BELOW THE SINK

# TYPE A - OPTION 2

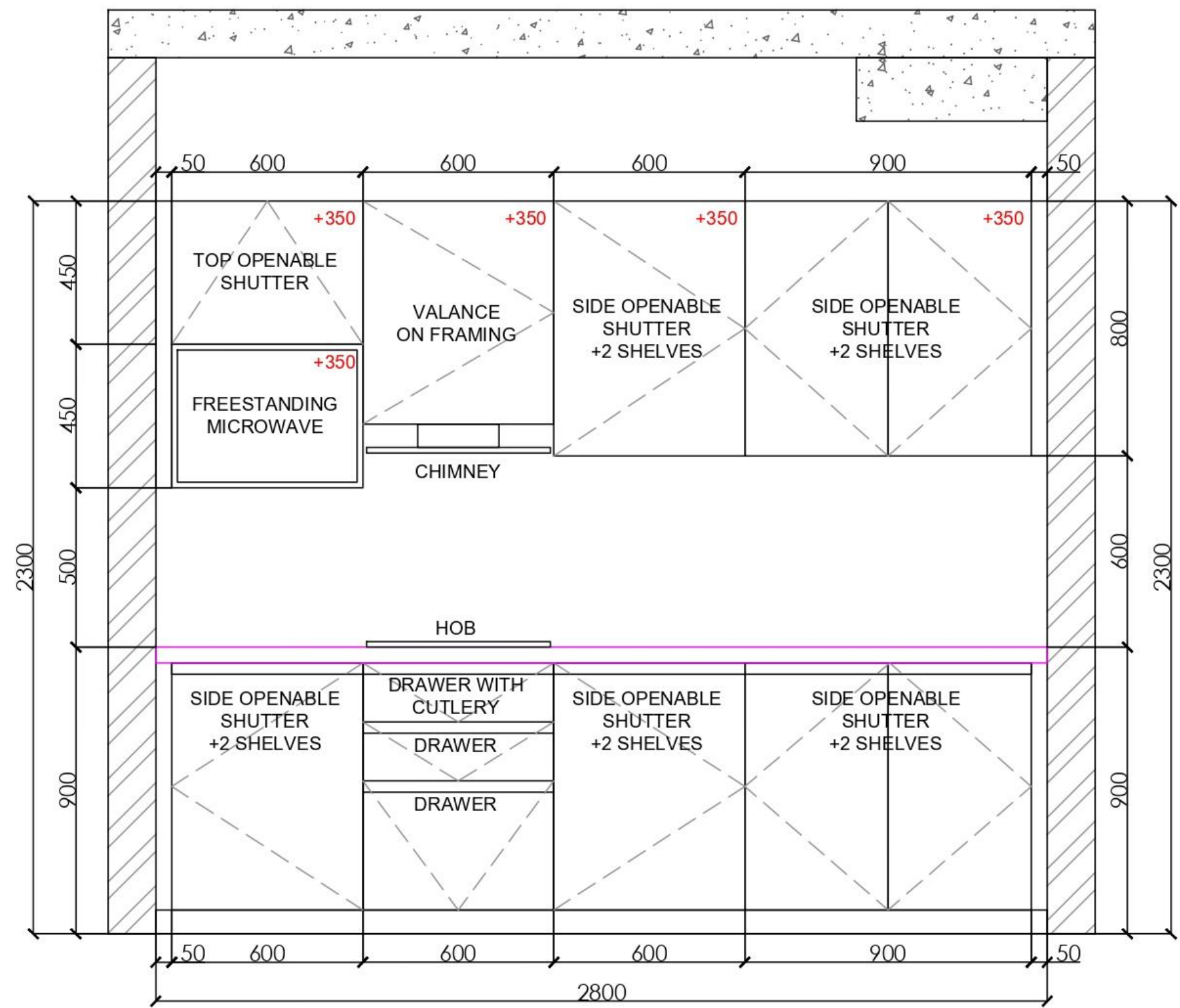

ELEVATION A

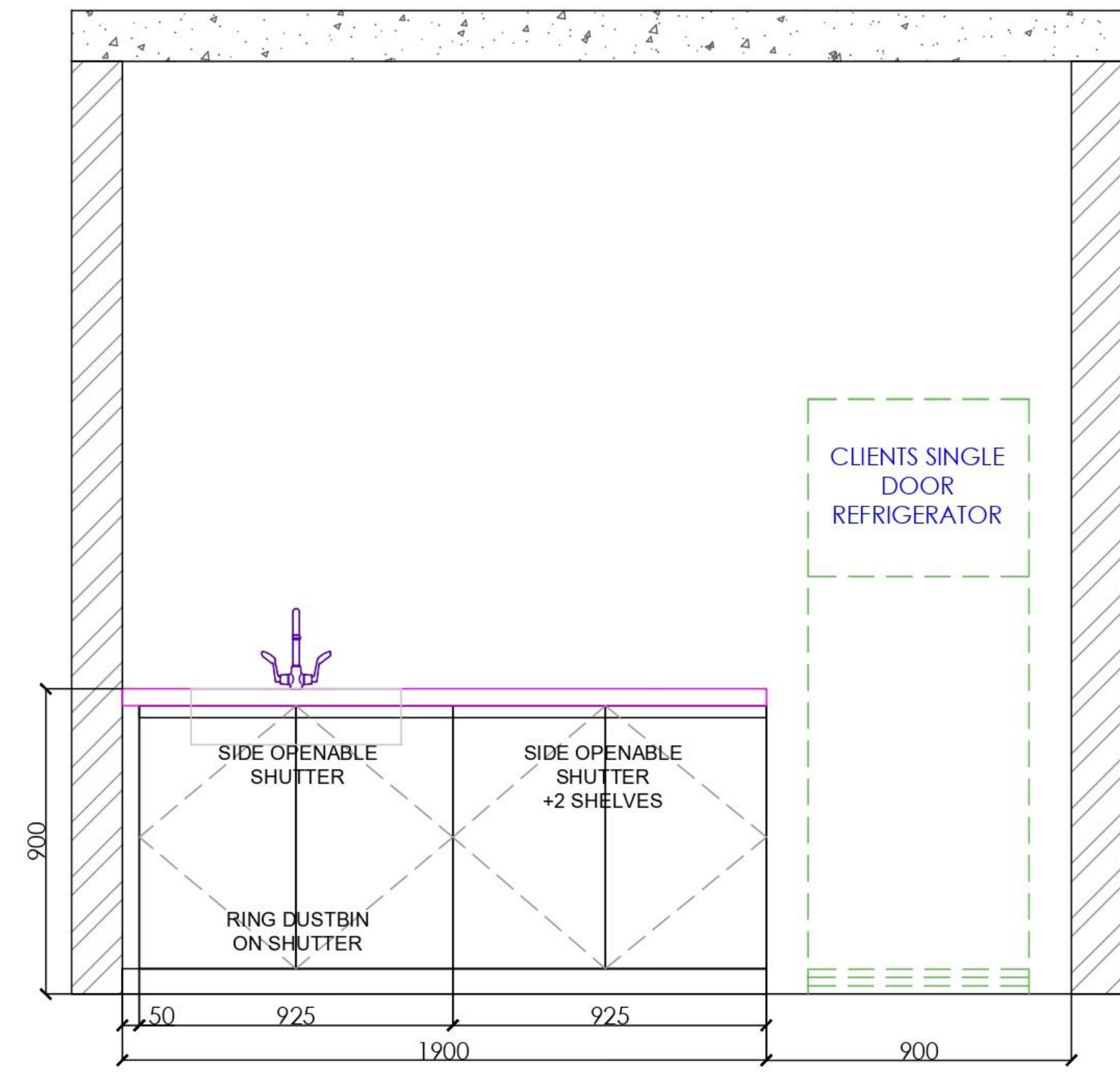

ELEVATION B

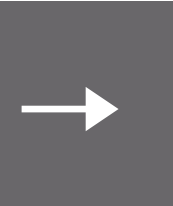



# TYPE A - OPTION 2 DETAIL



OPEN UNIT FOR MICROWAVE

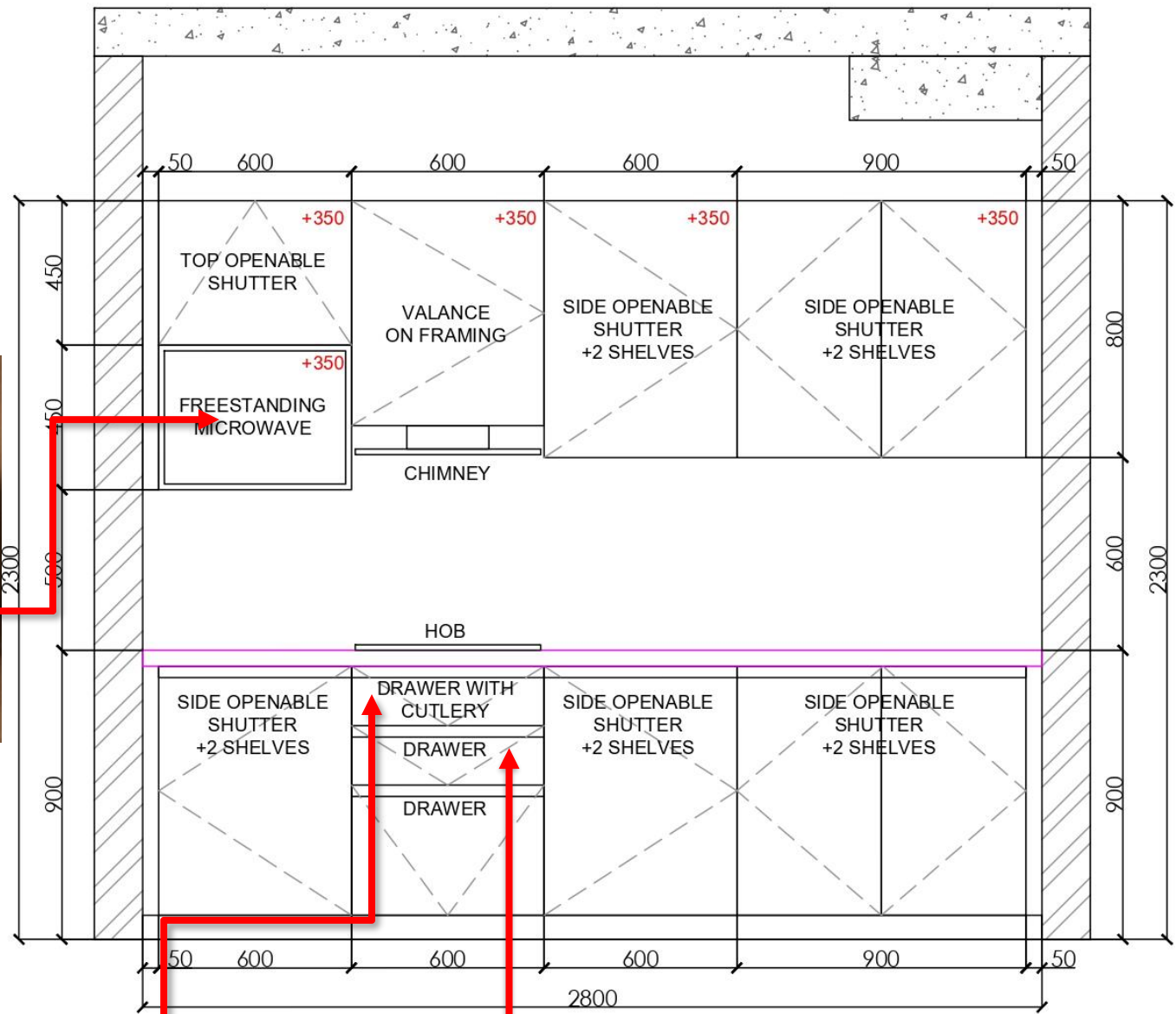

ELEVATION A



PVC CUTLERY TRAY



HETTICH-ATIRA DRAWER

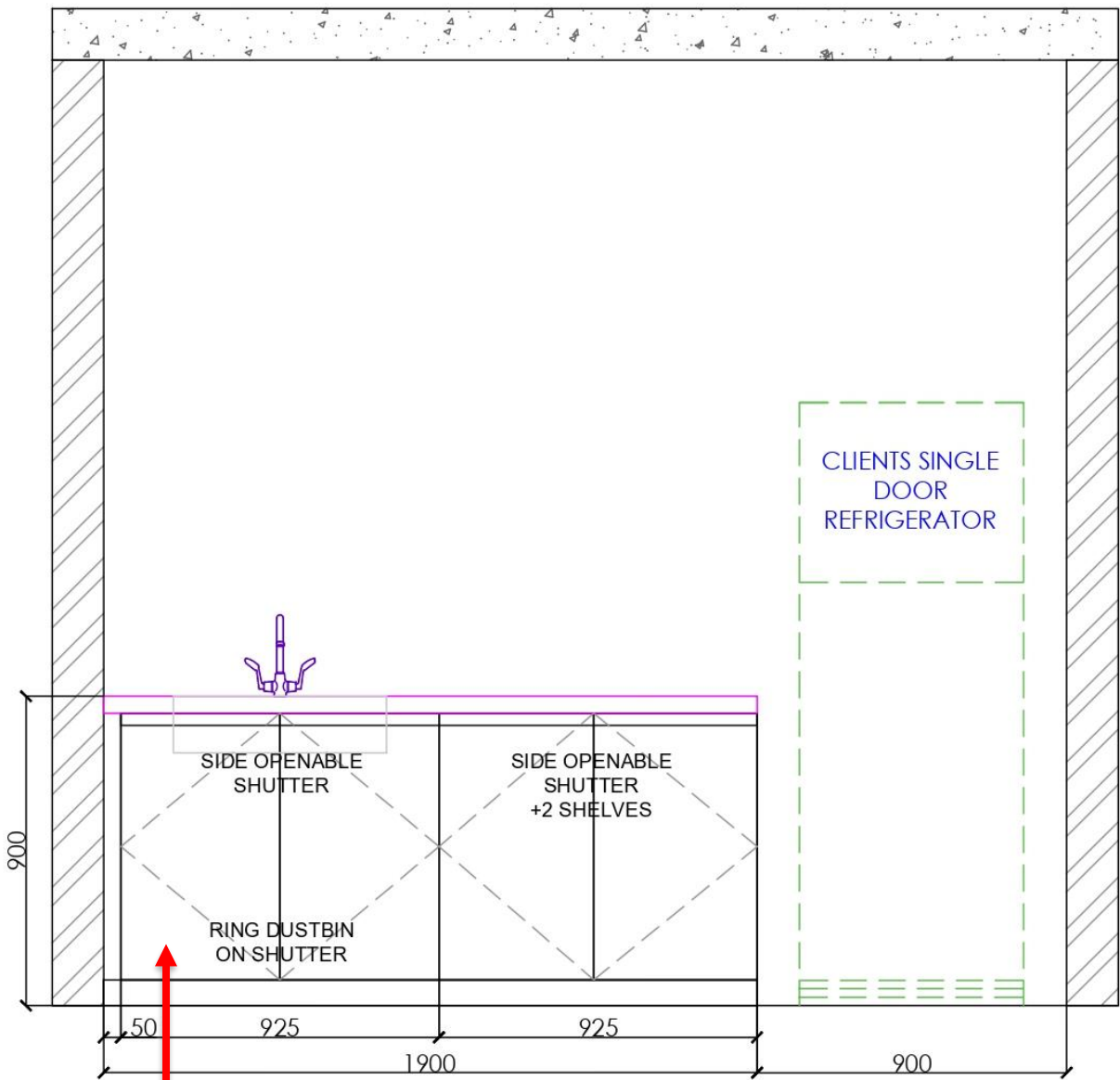

ELEVATION B



RING DUSTBIN BELOW THE SINK



# TYPE A - OPTION 3

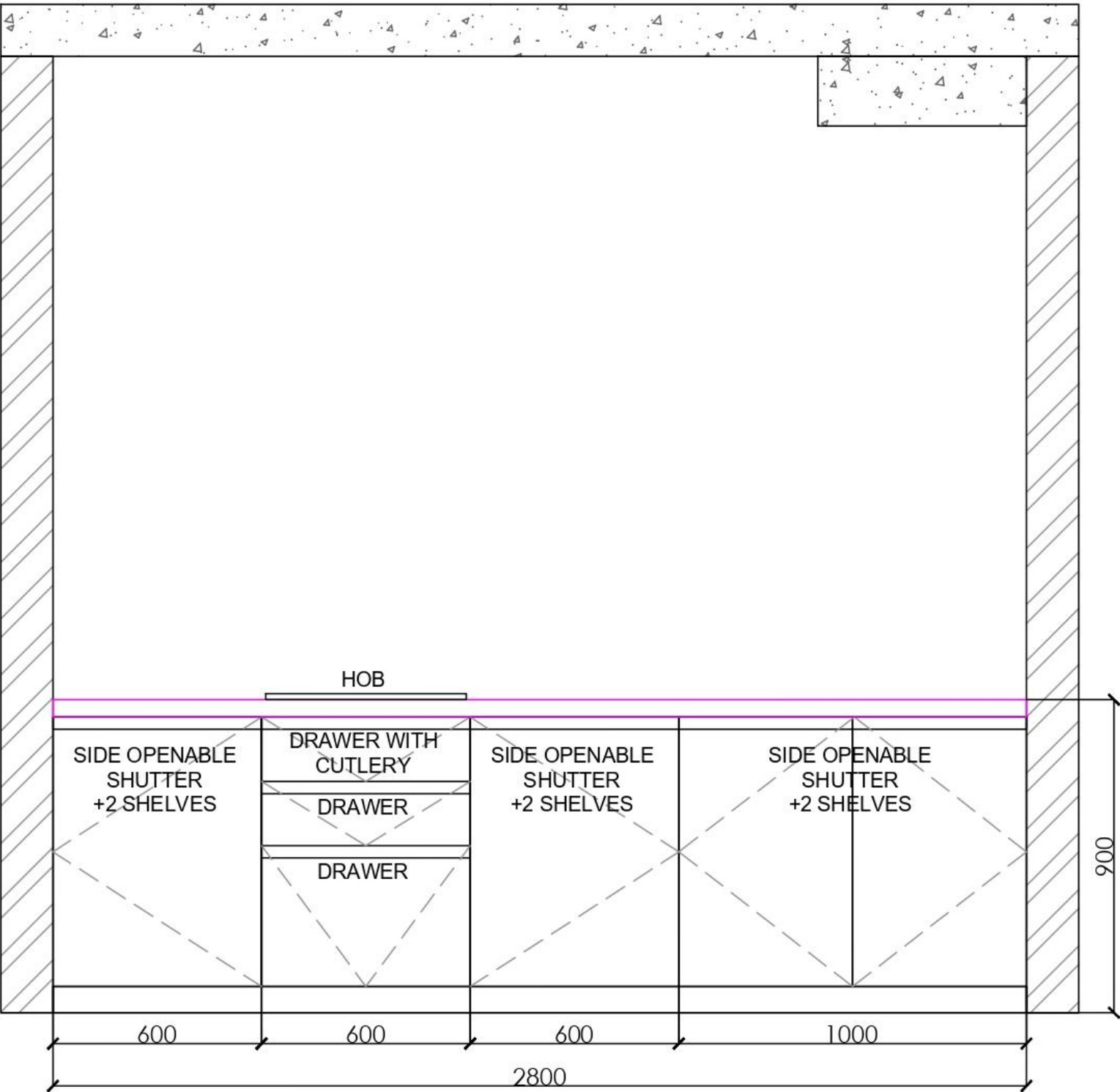

ELEVATION A

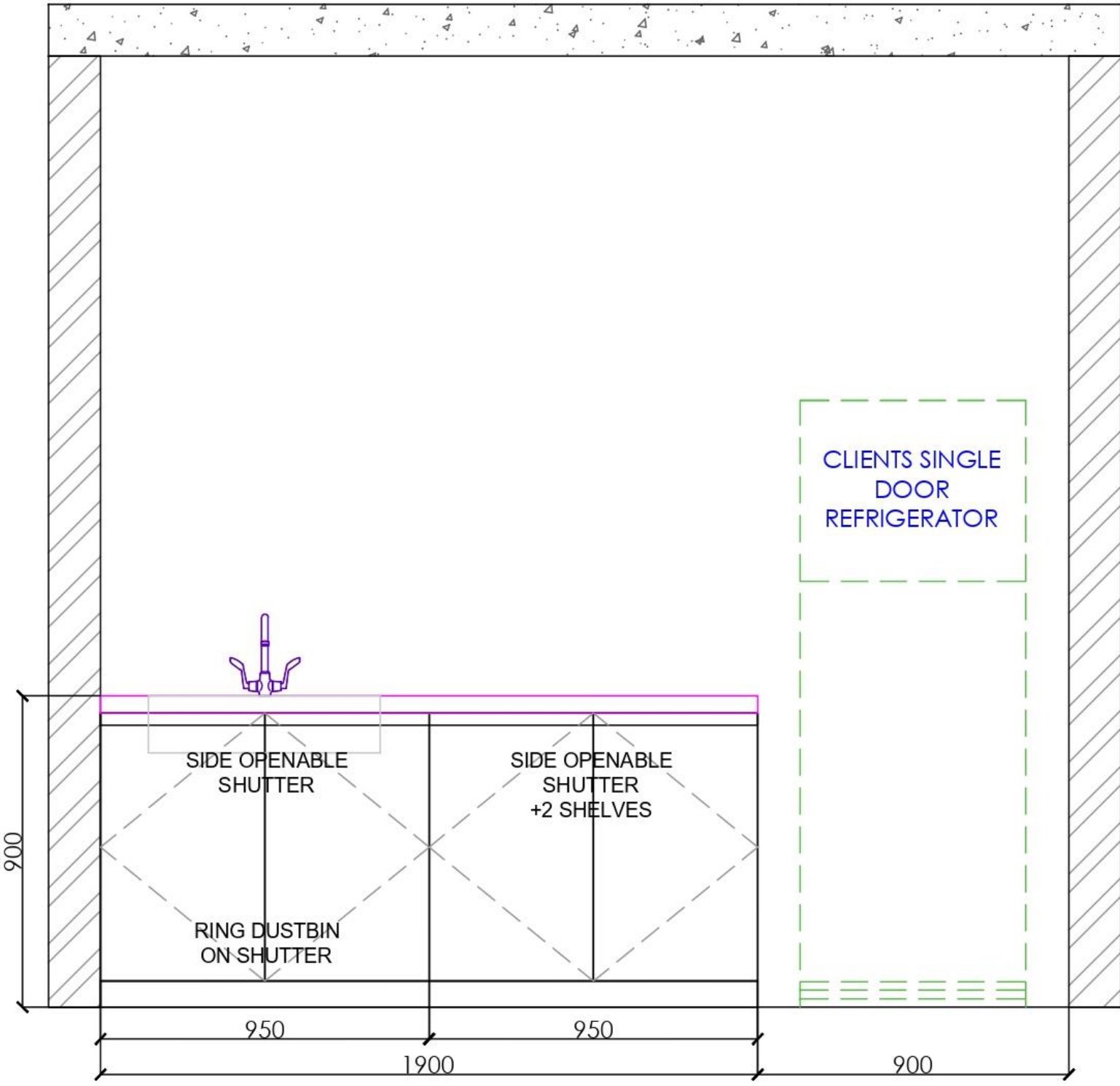

ELEVATION B



# TYPE A - OPTION 3 DETAIL

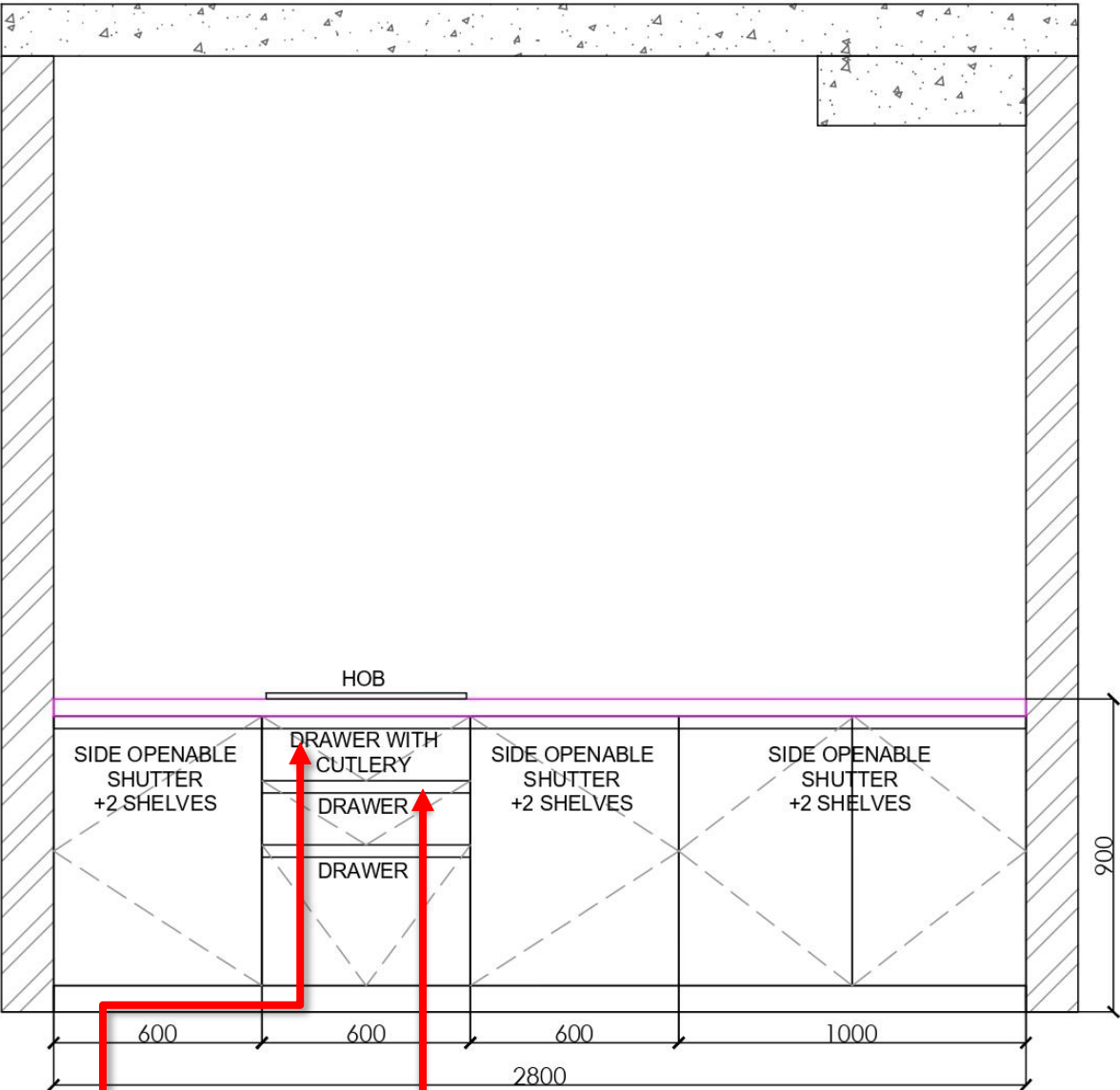

ELEVATION A



PVC CUTLERY TRAY



HETTICH-ATIRA DRAWER

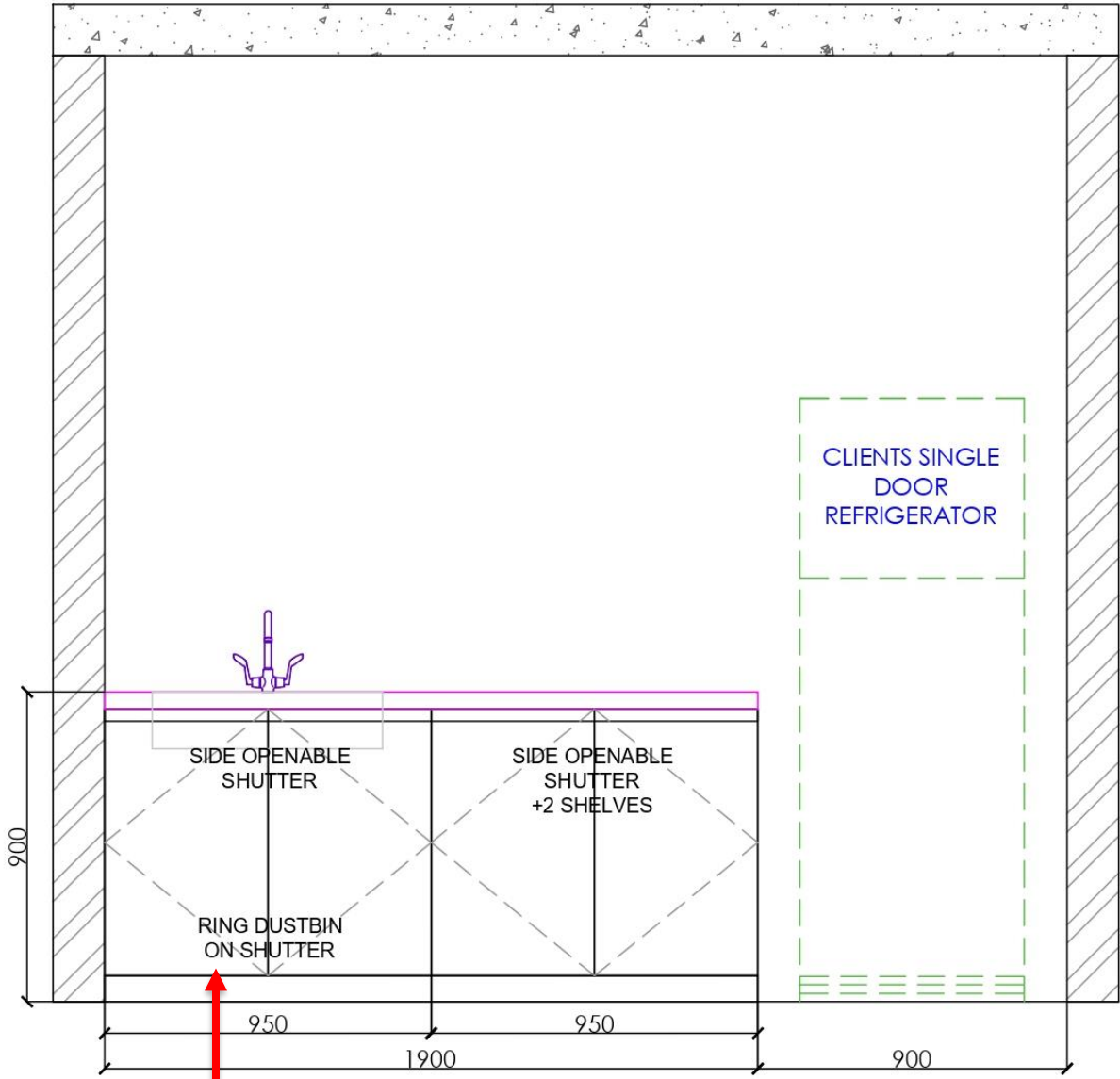

ELEVATION B



RING DUSTBIN BELOW  
THE SINK



# TYPE B - KITCHEN LAYOUT

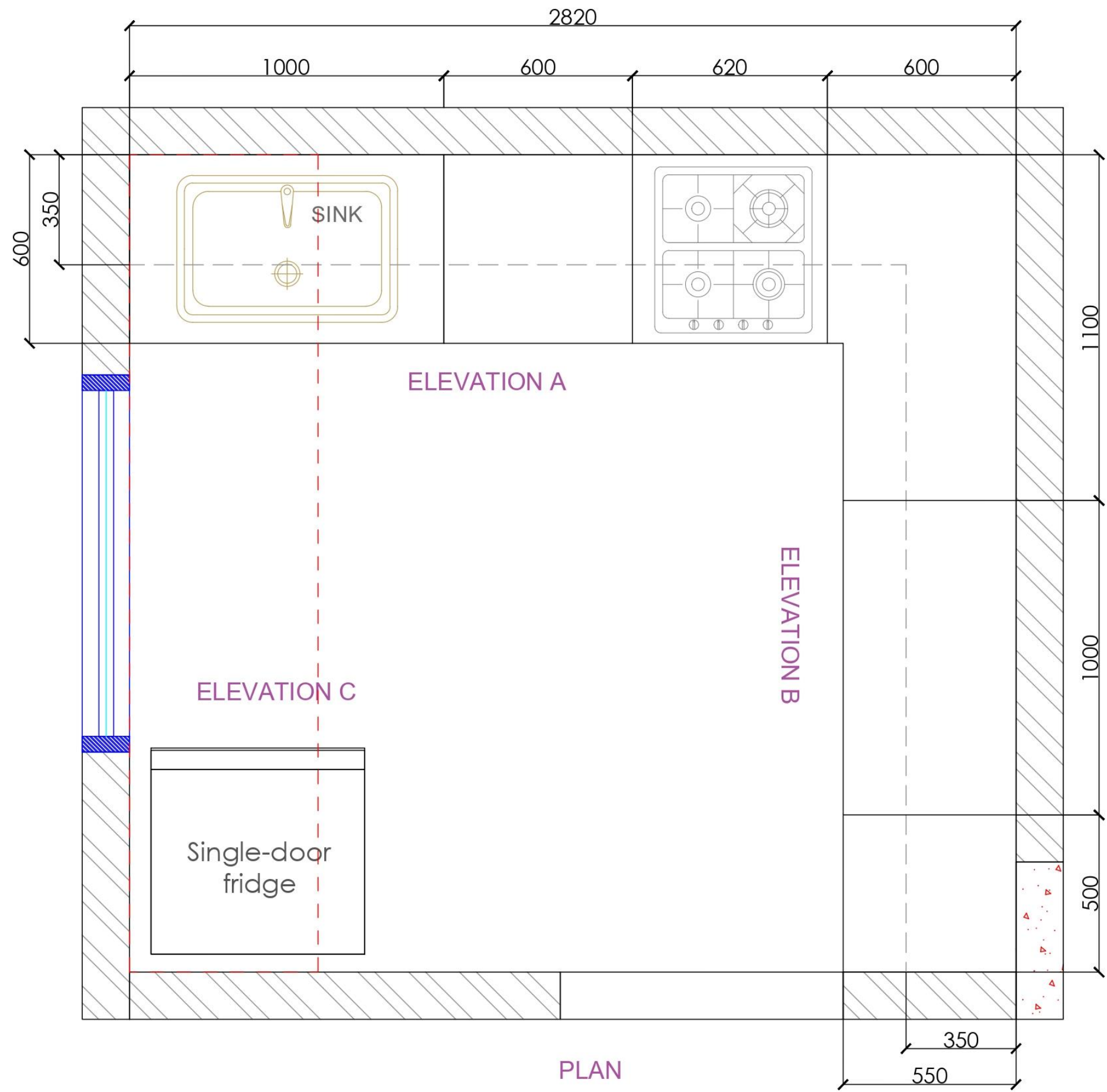

# TYPE B - OPTION 1

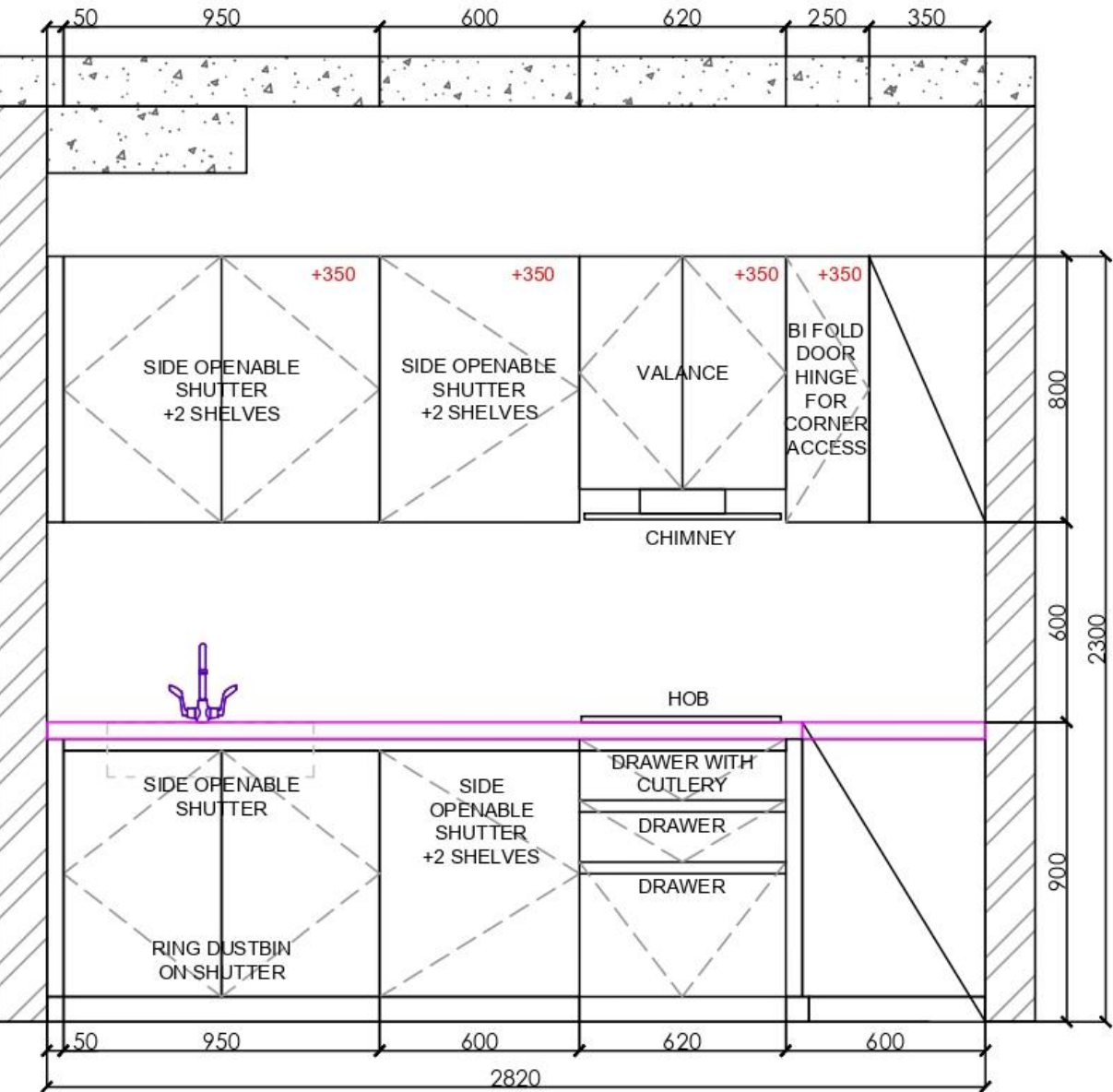

ELEVATION A

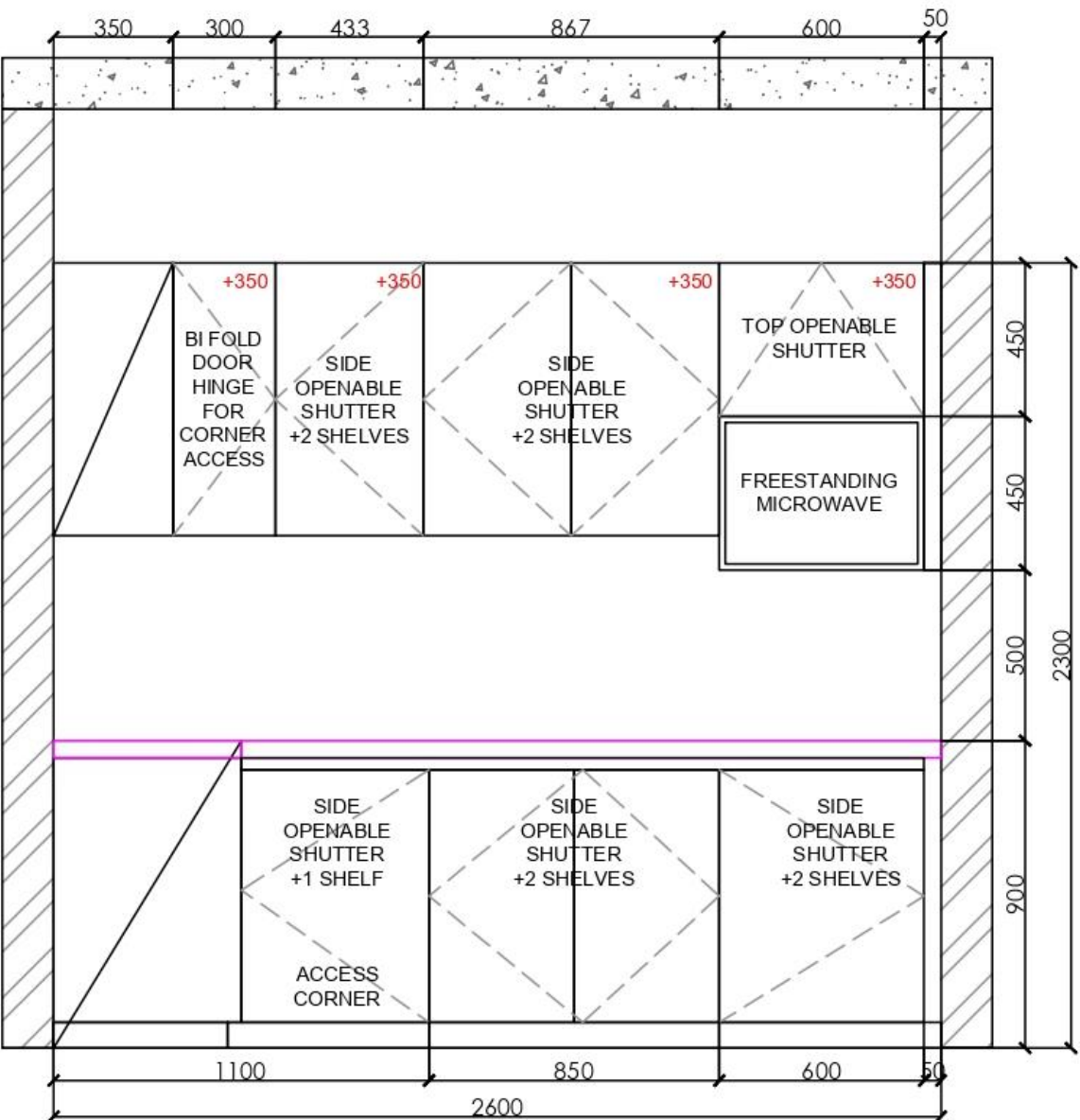

ELEVATION B

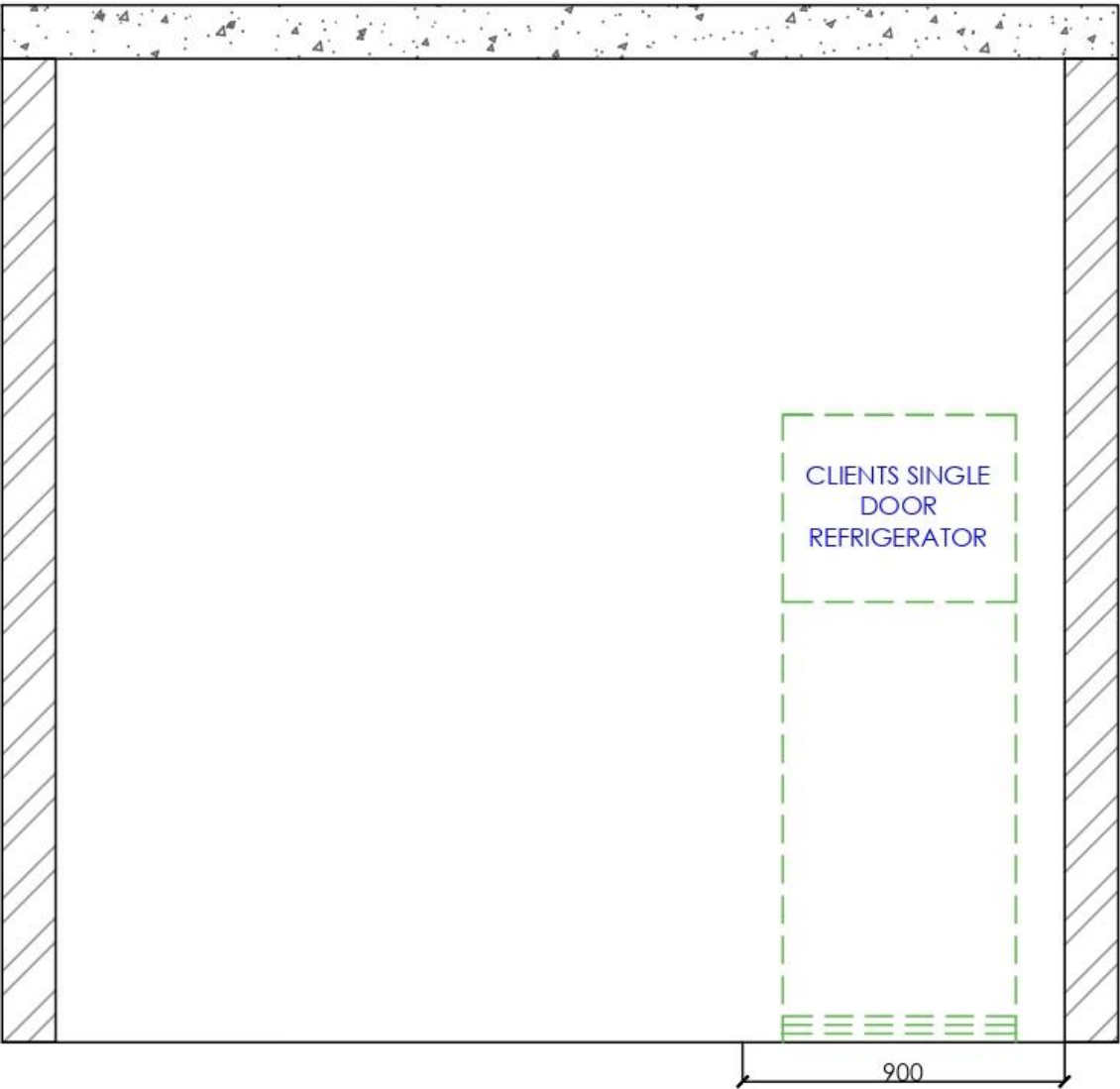

ELEVATION C

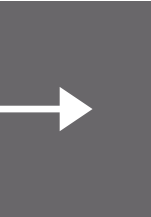



# TYPE B - OPTION 1 DETAIL

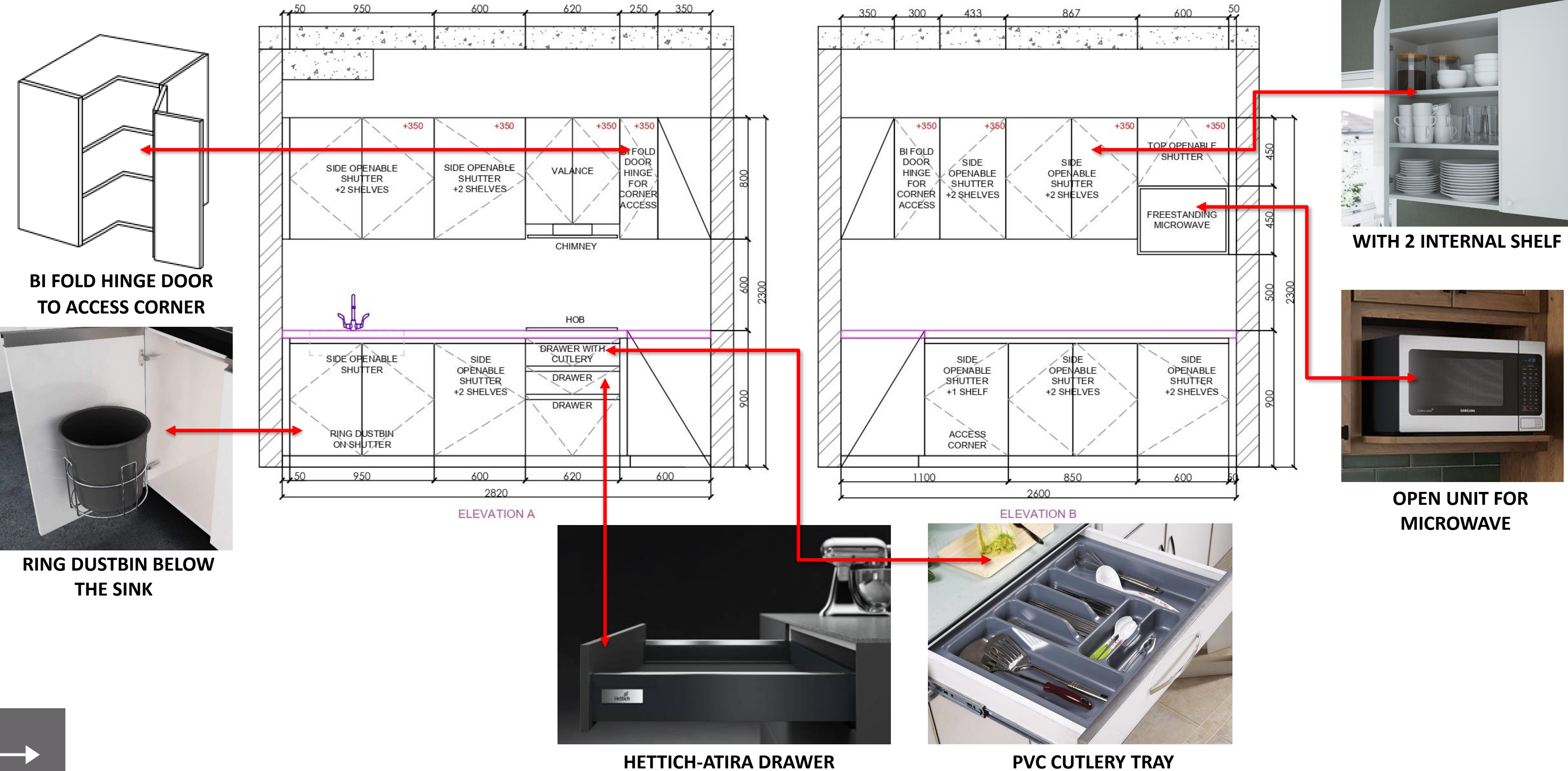

# TYPE B - OPTION 2

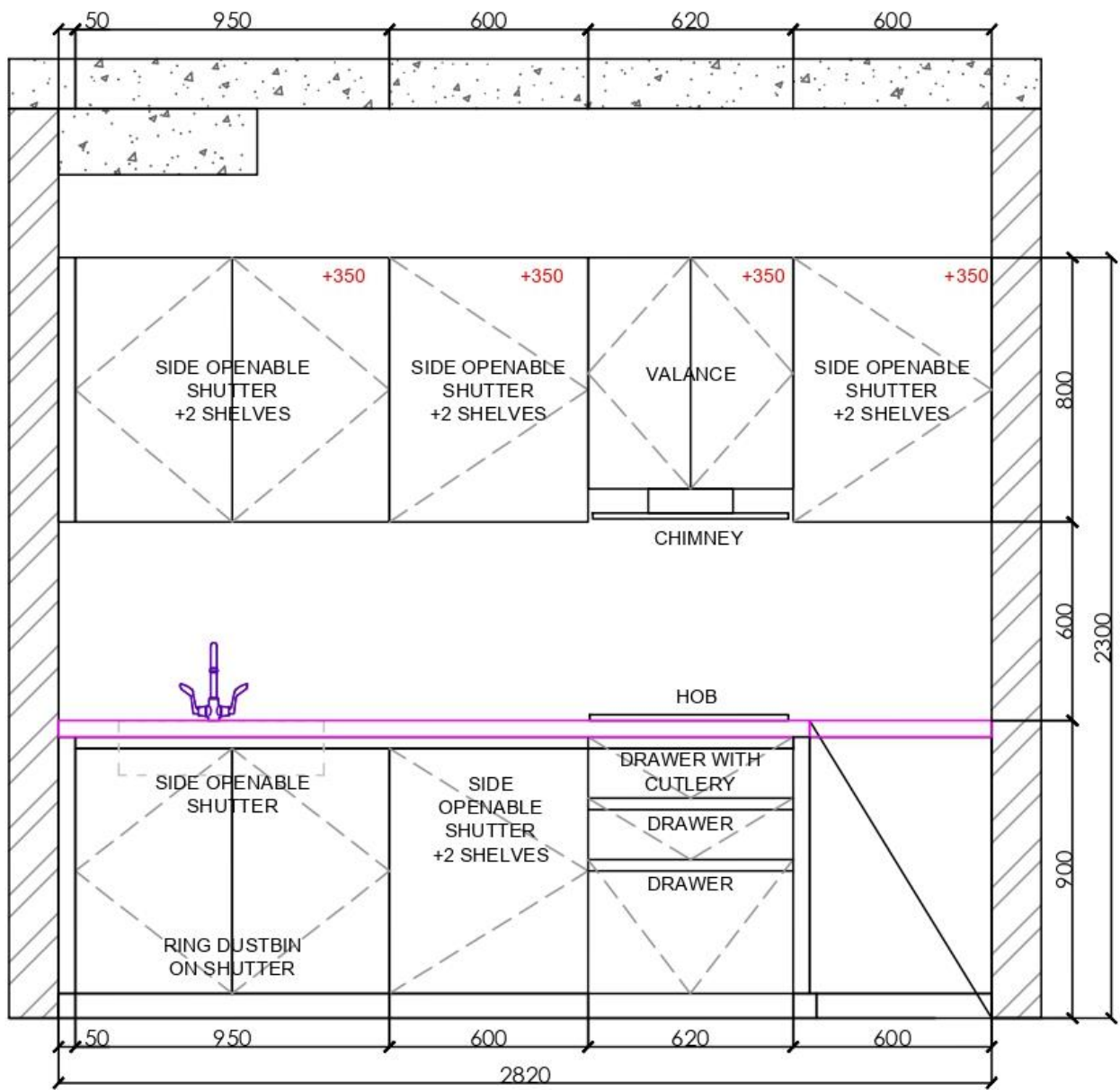

ELEVATION A

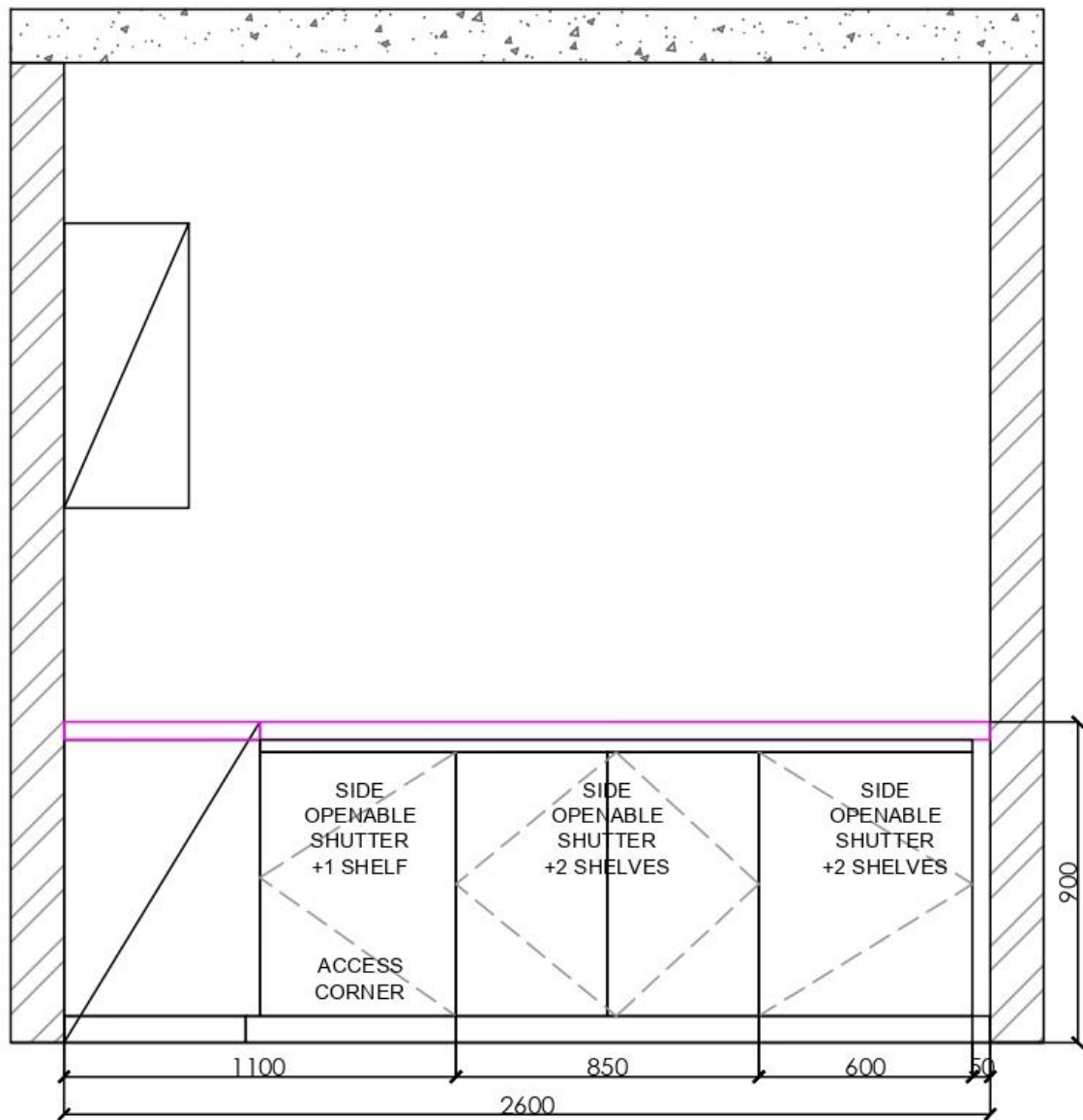

ELEVATION B

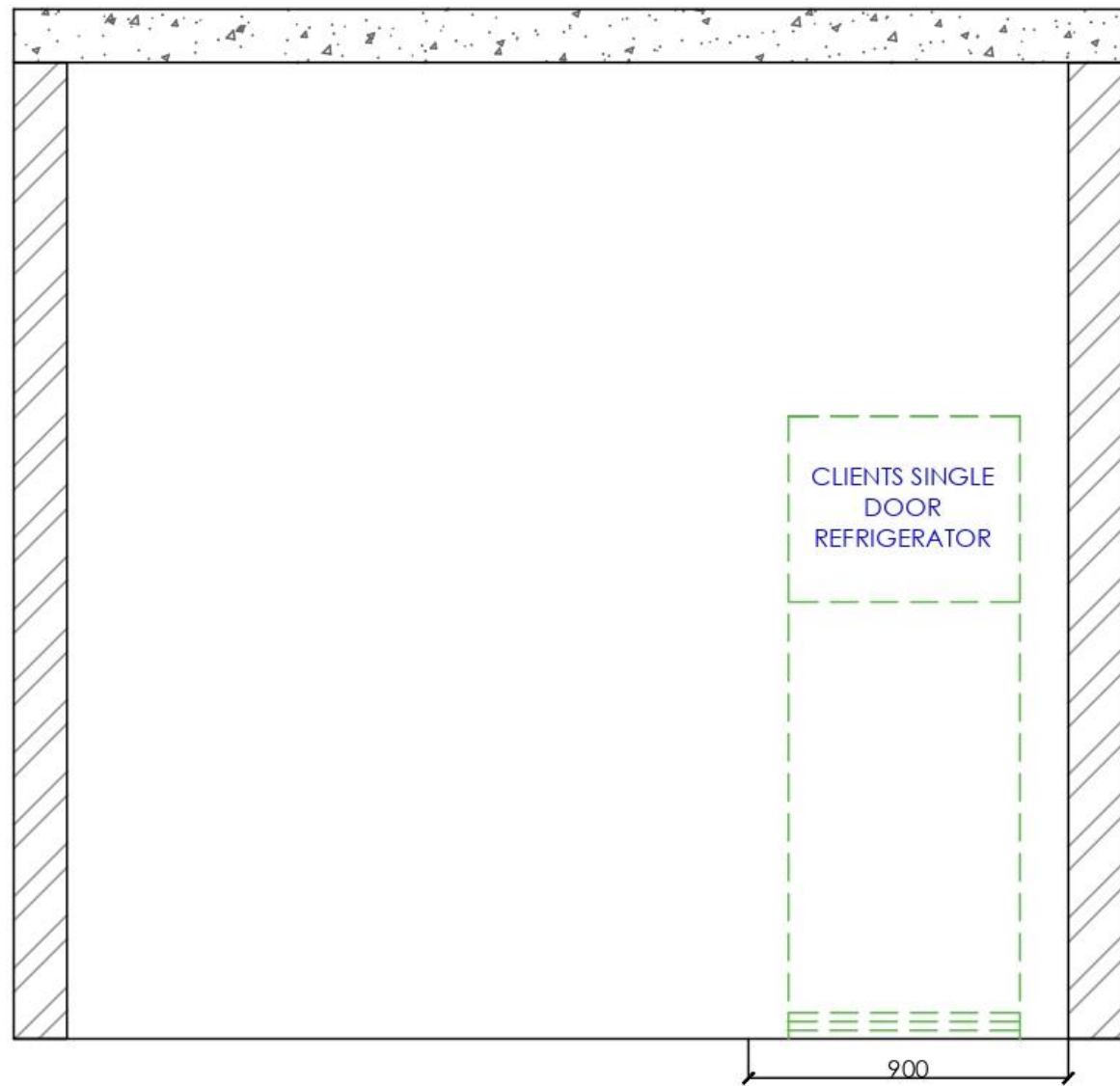

ELEVATION C

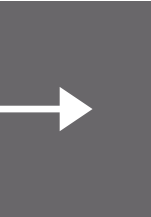



# TYPE B - OPTION 2 DETAIL



WITH 2 INTERNAL SHELF



RING DUSTBIN BELOW THE SINK

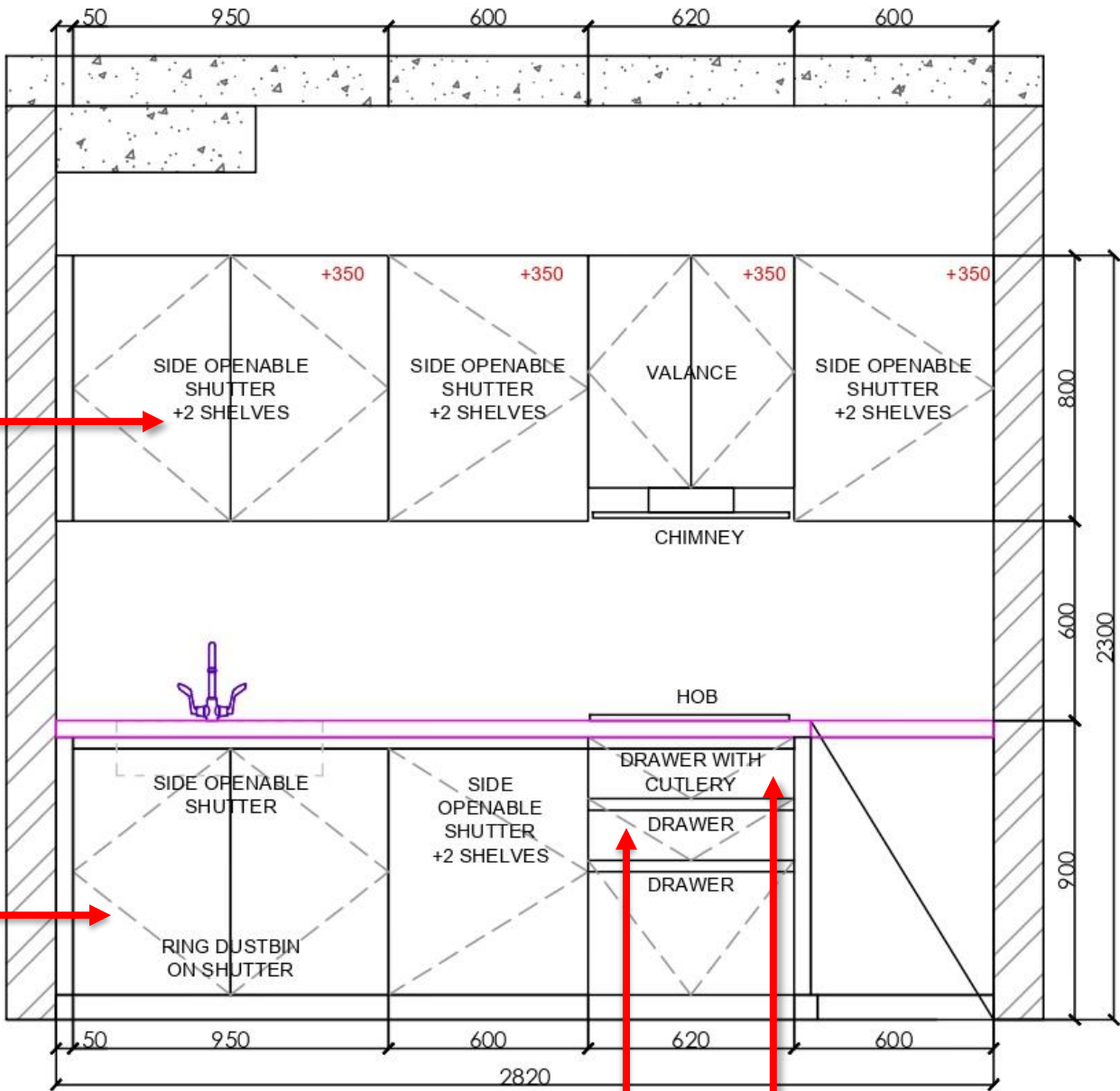

ELEVATION A

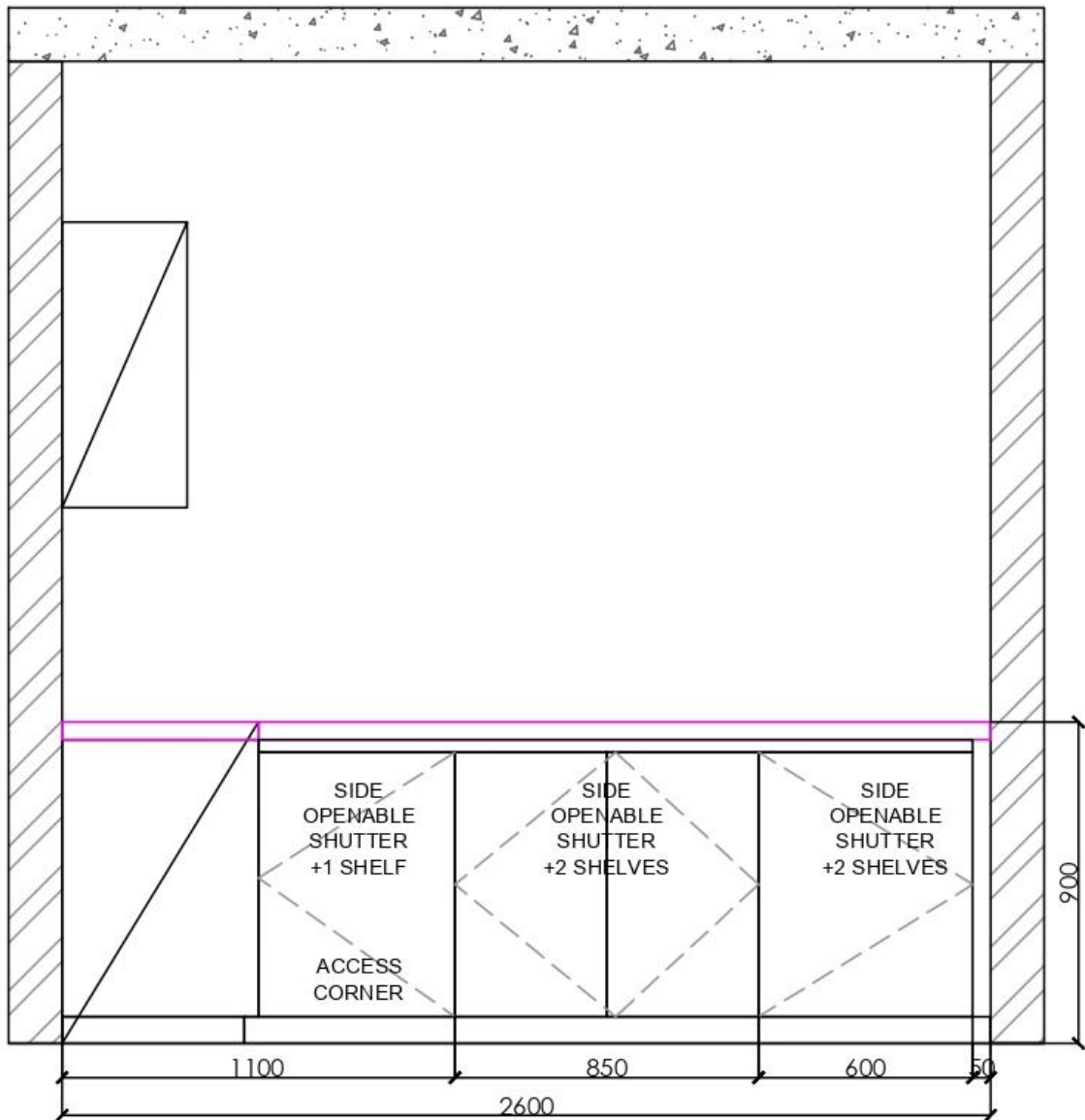

ELEVATION B



HETTICH-ATIRA DRAWER



PVC CUTLERY TRAY



# TYPE B - OPTION 3

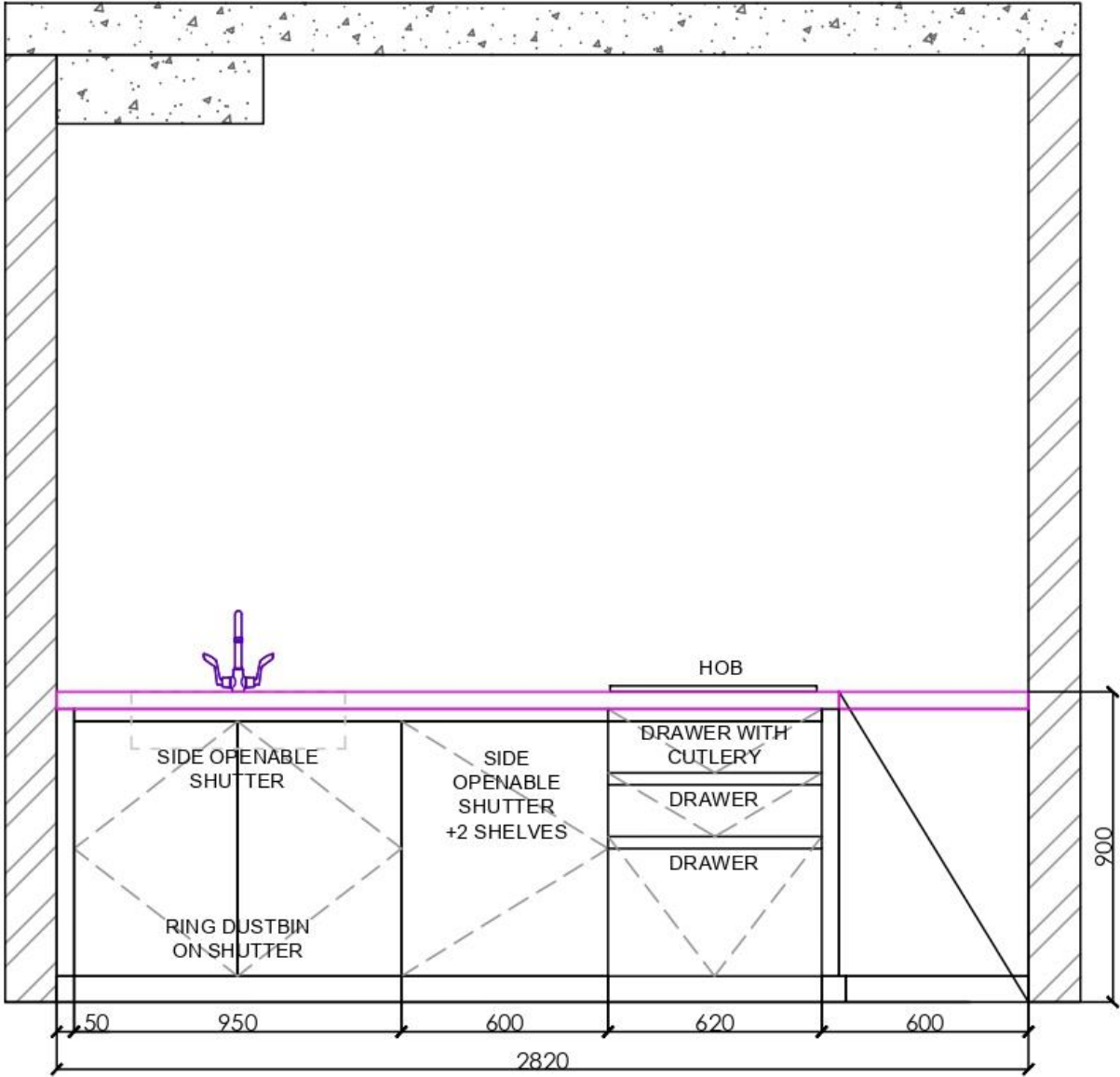

ELEVATION A

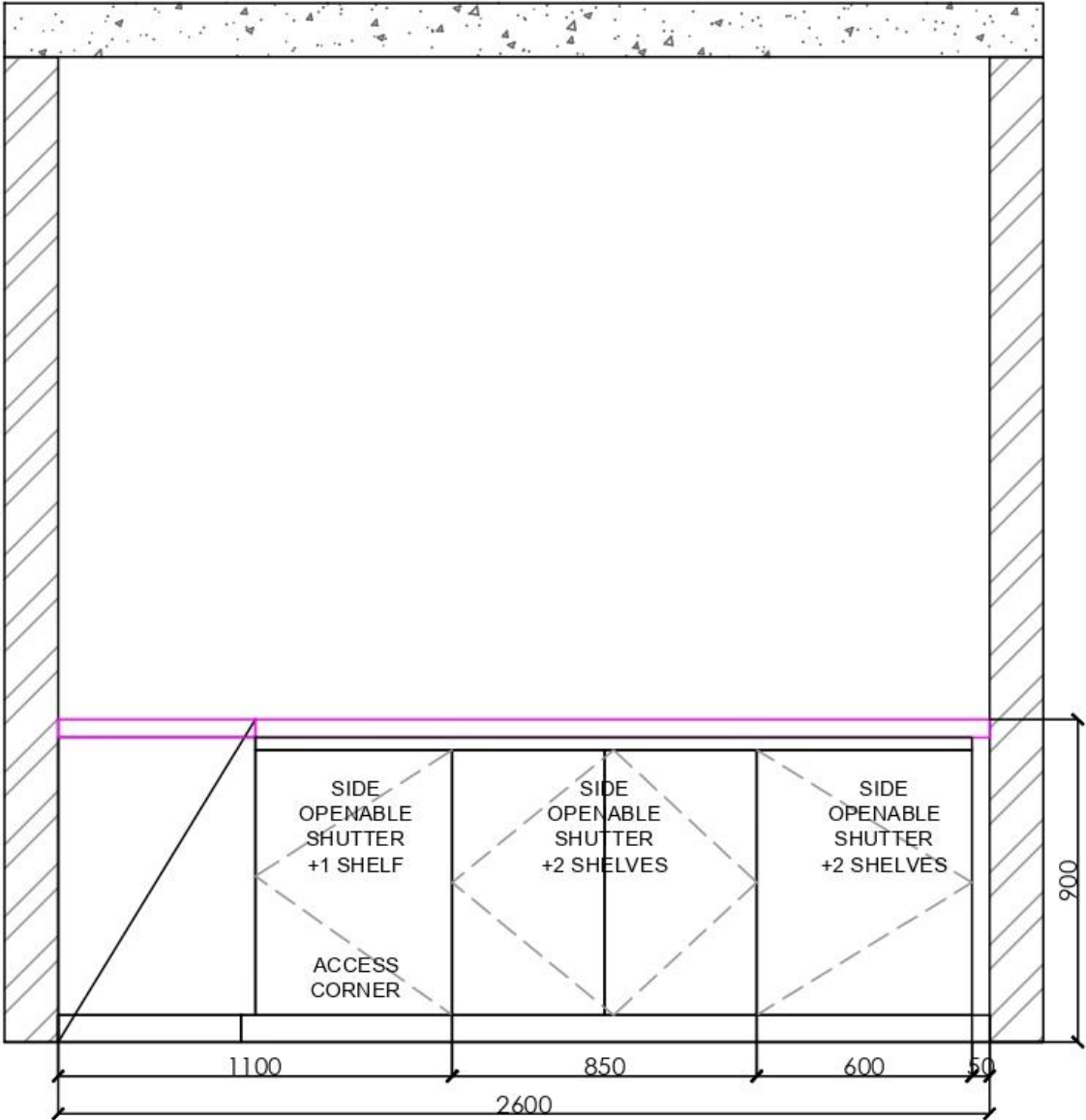

ELEVATION B

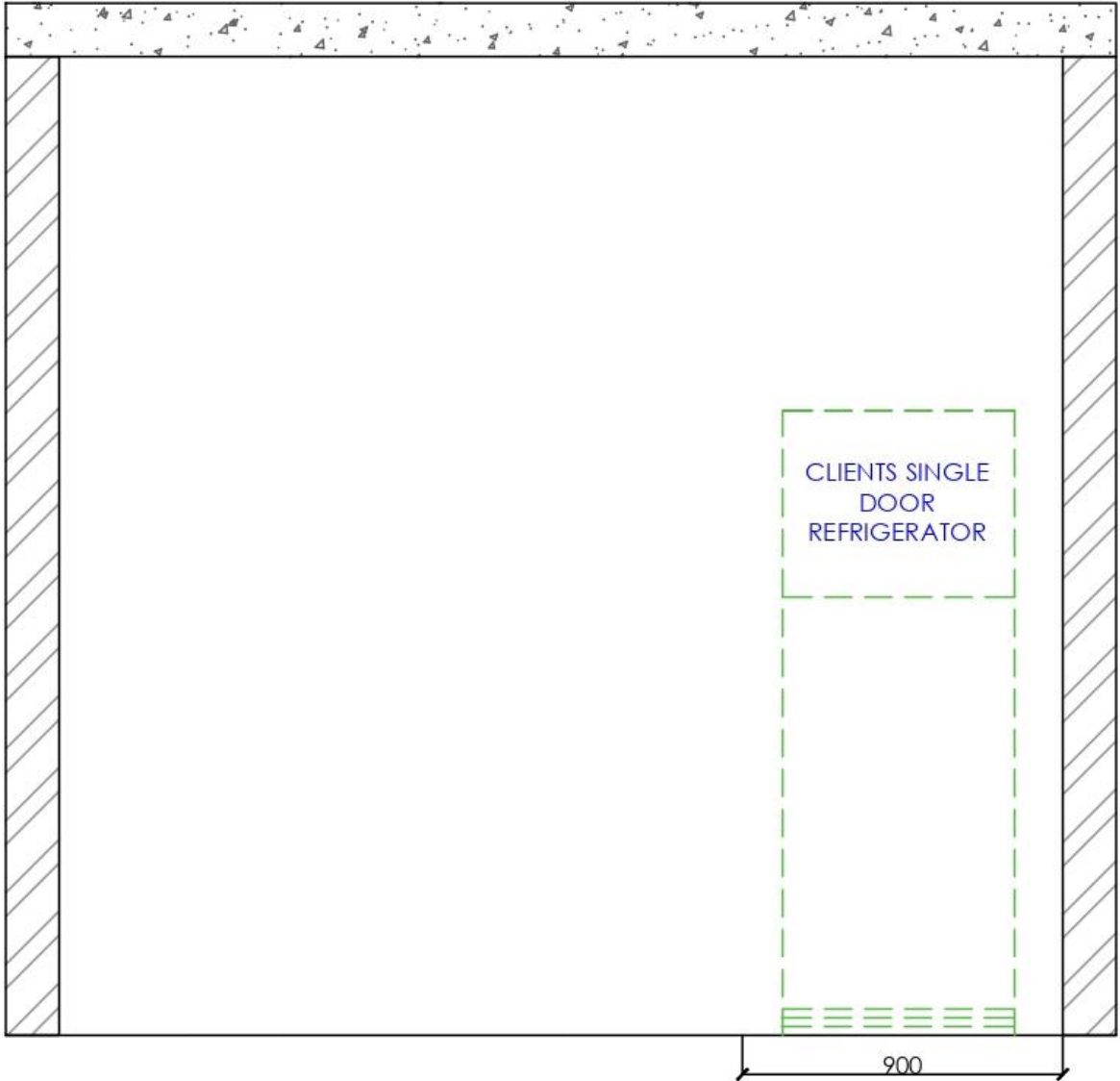

ELEVATION C





# TYPE B - OPTION 3 DETAIL



RING DUSTBIN BELOW THE SINK

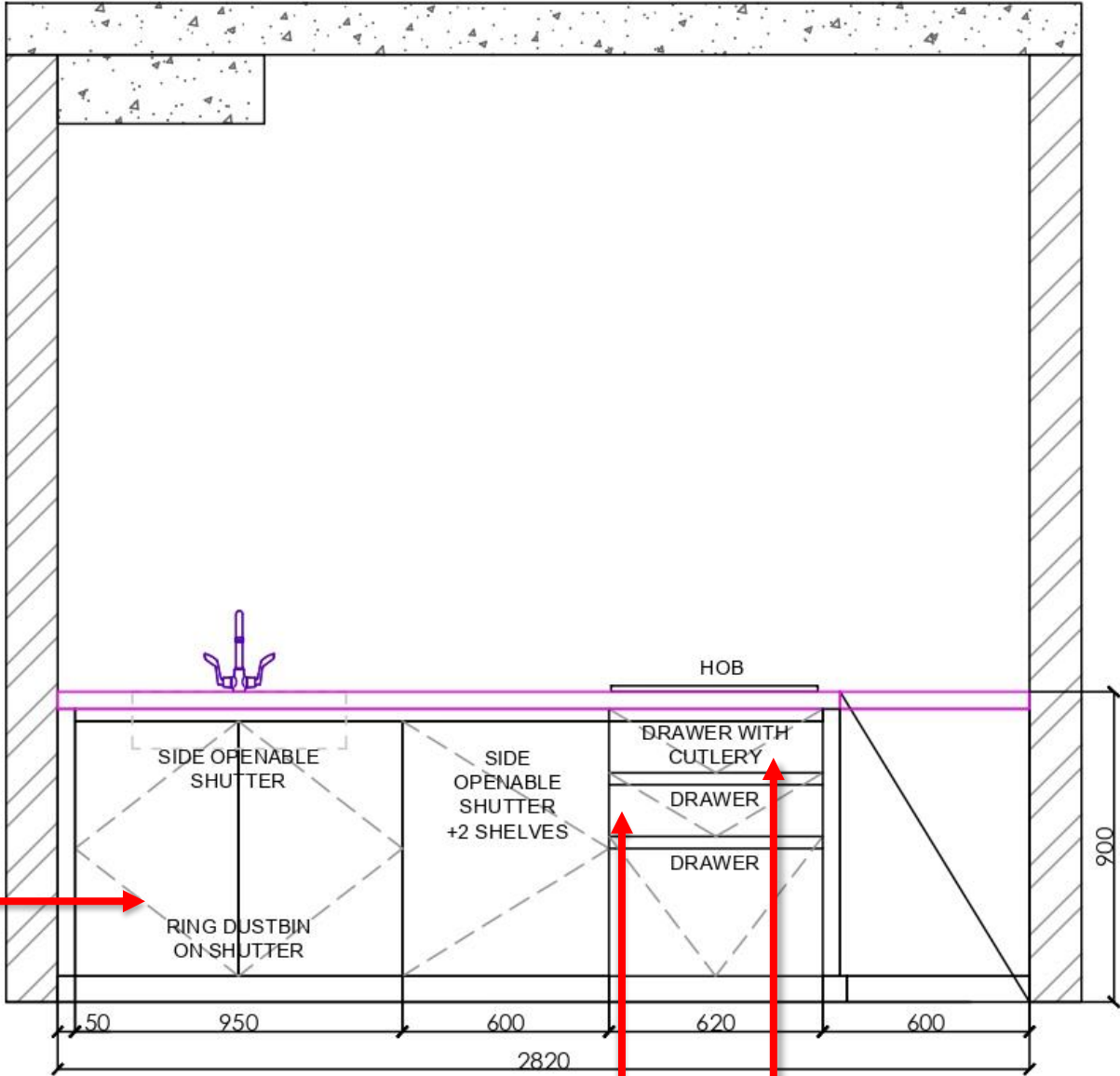

ELEVATION A

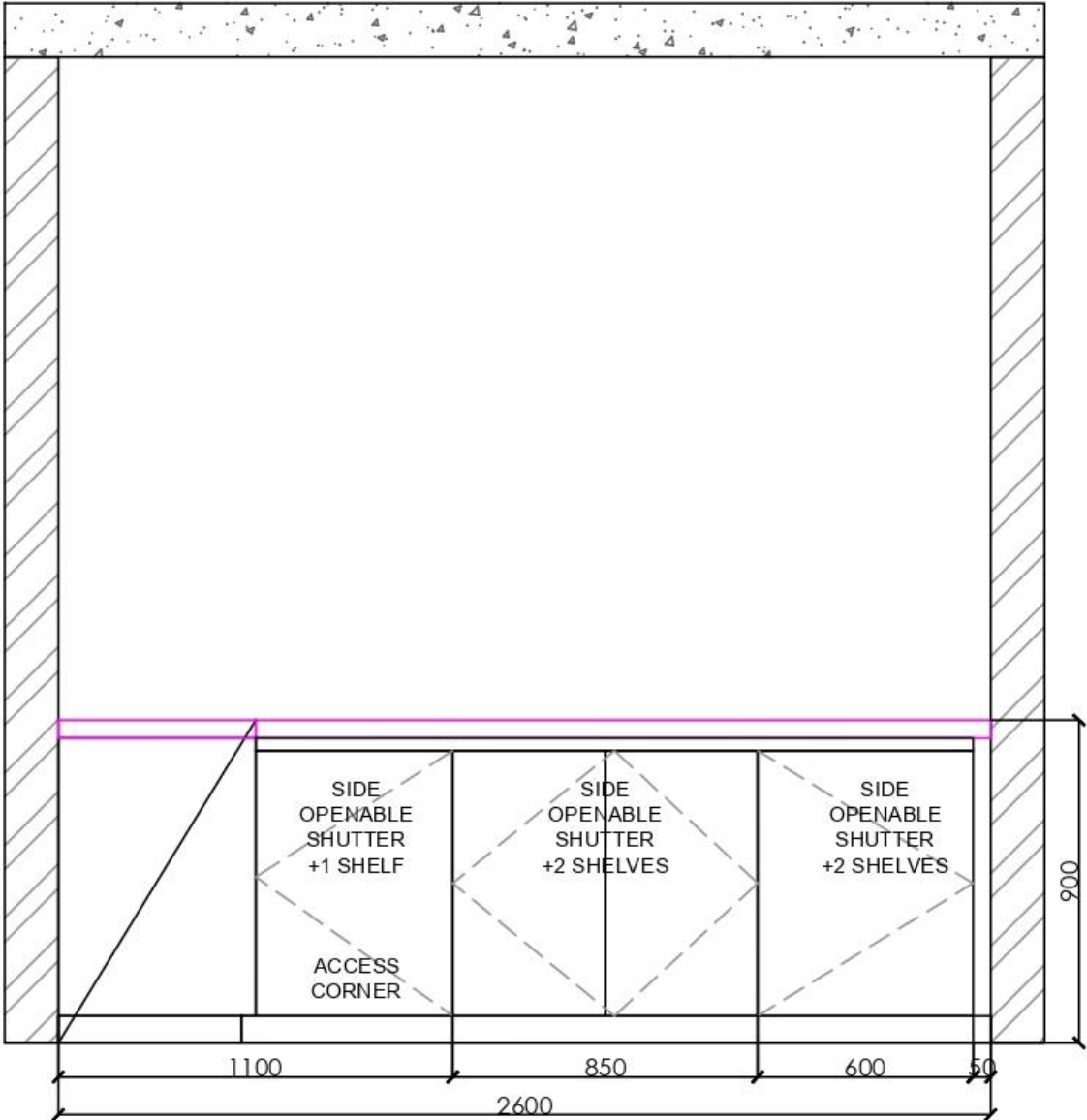

ELEVATION B



HETTICH-ATIRA DRAWER



PVC CUTLERY TRAY



# PROPOSED HARDWARE

PLEASE NOTE : IMAGES SHOWN ARE FOR REPRESENTATION PURPOSE ONLY



HETTICH : ATIRA DRAWERS



HETTICH : ATIRA DRAWERS



600MM PVC CUTLERY  
TRAY – 1NOS

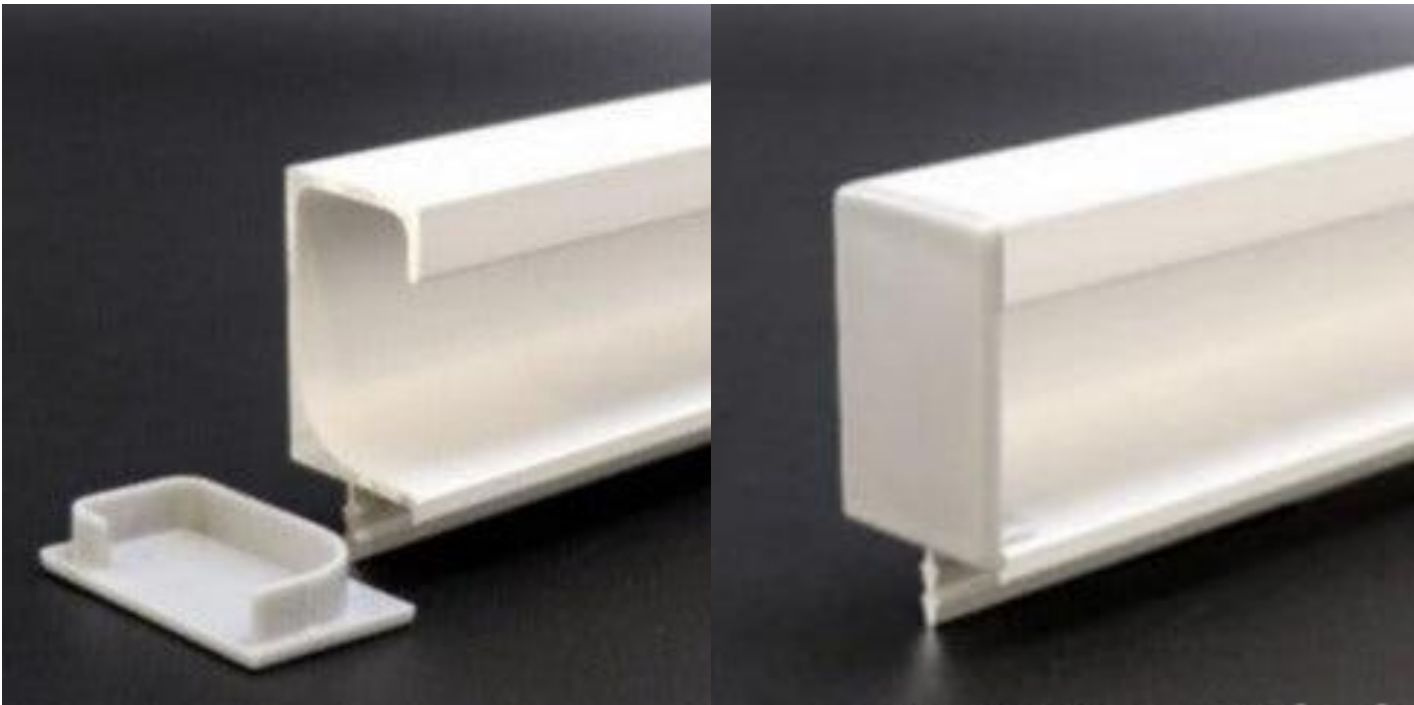

G SECTION HANDLE IN  
BLACK FINISH





# AWARDS AND RECOGNITION



ACETECH 2019-MUMBAI

GRANDSTAND AWARD -  
PLATINUM



ECONOMIC TIMES

PROMISING BRANDS 2019-  
2020



SILICONINDIA

BRAND OF THE YEAR 2019.



# Connect with us



KITCHENSTUDIO INDIA



KITCHENSTUDIO INDIA



KITCHENSTUDIO INDIA



HOTLINE WHATSAPP  
NUMBER: 8883625625



INFO@KITCHENSTUDIO.IN  
KITCHENSTUDIOMUMBAI@GMAIL.COM

## Andheri (Corporate office)

8, Remi Commercio, Behind Yashraj Studios Back gate, Shaha Industrial Estate, Off New Link road, Andheri (W) , Mumbai- 400053.

## Nahur

Shop No 4, Ram Chandra Patil Chawl, Opposite Runwal Green, Mulund Link road, Mulund, Mumbai- 400080.

## Lower Parel

3rd floor, Block 6, Shakti Mills Ln, Mahalakshmi, Mumbai- 400011